

The product using material and processing must conform to the "WL-PZ-001" HSF technical standard control requirements



NOTE:
 1.MATERIAL SPECIFICATION:
 1-1.HOUSING: PBT,94V-0
 1-2.CONTACTS: BRASS
 2.PLATING SPECIFICATION:
 2-1.CONTACTS:
 TIN/GOLD FLASH PLATED OVER ALL.
 3.MECHANICAL PERFORMANCE:
 3-1.RETENTIVITY FORCE: 0.8KGF/pin min
 3-2.DURABILITY: 100 CYCLES.
 4.ELECTRICAL PERFORMANCE:
 4-1.CURRENT RATING: 3A AC/DC
 RATED VOLTAGE : 250V AC
 4-2.CONTACT RESISTANCE: 20 mΩ MAX
 4-3.INSULATION RESISTANCE: 1000MΩ Min
 4-4.DIELECTRIC WITHSTANDING : 1000V
 5.ENVIRONMENTAL PERFORMANCE:
 5-1.OPERATING TEMPERATURE: -40°C~+105°C.
 6.PACKAGE SPEC: TRAY
 7.P/N:

D25530 M 0-2 XX 6 X X X
 SERIES NO: M 0-2 XX 6 X X X TYPE:
 O-THREE PIECE
 1-TWO PIECE
 MALE FEMALE: M-MALE COLOR:
 A-BLACK
 J-GREY
 S-NATURE
 ANGLE: 0-180° PLATING:
 1-G/F
 2-DOUBLE ROW R-G/F 1u"
 ROW NO: PIN Q'PY: 06~64
 TERMPOINT: 6-PUNCTURE TYPE

A
B
C
D
E
F
G
H

A
B
C
D
E
F
G
H

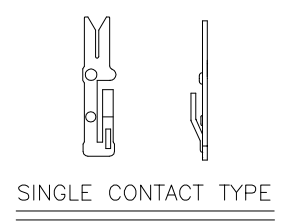
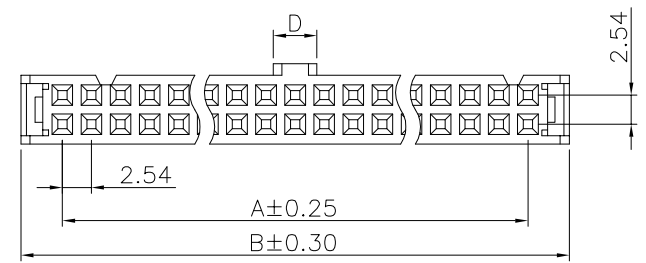
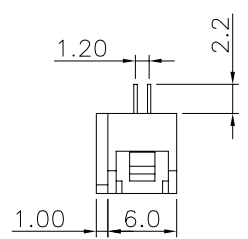
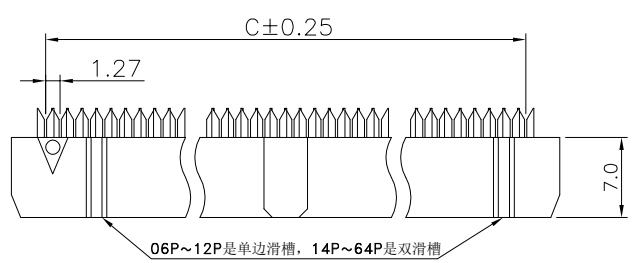
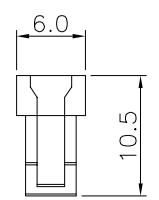
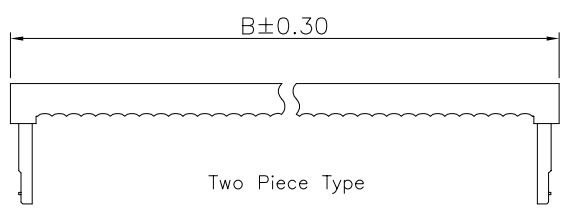
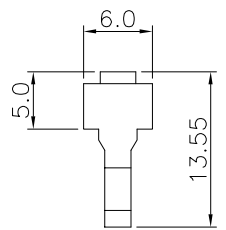
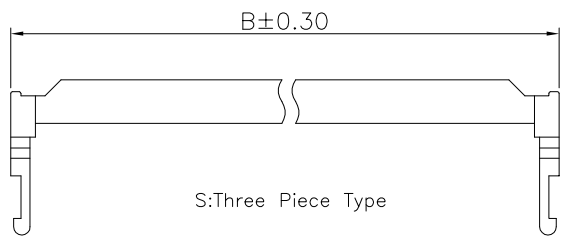

Poles	Dimensions(mm)				Poles	Dimensions(mm)			
	A	B	C	D		A	B	C	D
06	5.08	12.32	6.35	1.90	28	33.02	40.26	34.29	3.80
08	7.62	14.86	8.89	1.90	30	35.56	42.80	36.83	3.80
10	10.16	17.40	11.43	3.80	32	38.10	45.34	39.37	3.80
12	12.70	19.94	13.97	3.80	34	40.64	47.88	41.91	3.80
14	15.24	22.48	16.51	3.80	36	43.18	50.42	44.45	3.80
16	17.78	25.02	19.05	3.80	40	48.26	55.50	49.53	3.80
18	20.32	27.56	21.59	3.80	44	53.34	60.58	54.61	3.80
20	22.86	30.10	24.13	3.80	50	60.96	68.20	62.23	3.80
22	25.40	32.64	26.67	3.80	60	73.66	80.90	74.93	3.80
24	27.94	35.18	29.21	3.80	64	78.74	85.98	80.01	3.80
26	30.48	37.72	31.75	3.80					

REV.	REVISION RECORD	DATE		GENERAL TOLERANCES		SCALE: 1:1	NAME	DATE	PART.NO: D25530M0-2XX6XXX	DWG.NO: ENDE05	 WanLian Technology Co., Ltd
AO	NEW RELEASE	21.11.17		LINEAR	ANGLES	APPROVED	Wang_jr	21.11.17			
				0.0±0.35	X'REF±6'	DESIGNER	Han_Gao	21.11.17	TITLE:		
				UNIT:mm	X'±3'	DRAWN	Zijun_Huang	21.11.17	Pitch 2.54mm 180° 双排 DIP IDC		
			SIZE: A4	0.000±0.10	X'X' ±2'				REV: A0	SHEET: 1/1	



广东万连科技有限公司 WanLian Teconology Co., Ltd

包 裝 規 範

PIN 数	PACKING METHODS CODE 包装方式	INNER PACKING No. 内包装材料号	INNER PACKING SIZE (mm) 包材规格			INNER PACKING Q'TY(PCS) 数量	INSIDE CARTON NO. 内箱料号	INSIDE CARTON SIZE (cm) 内箱规格			PCS/CARTON 数量	INSIDE 包装	CARTON NO. 外箱料号	CARTON NO. (mm) 外箱规格			KPCS / CARTON 数量	G.W REF. (KG) 毛重
			L / (D)	W	H / (L)			L	W	H				L	W	H		
06	C		305	260	9	264				7920			560	320	230	15.84		
08	C		305	260	9	216				6480			560	320	230	12.96		
10	C		305	260	9	192				5760			560	320	230	11.52		
12	C		305	260	9	156				4680			560	320	230	9.36		
14	C		305	260	9	144				4320			560	320	230	8.64		
16	C		305	260	9	132				3960			560	320	230	7.92		
18	C		305	260	9	120				3600			560	320	230	7.2		
20	C		305	260	9	108				3240			560	320	230	6.48		
22	C		305	260	9	96				2880			560	320	230	5.76		
24	C		305	260	9	84				2520			560	320	230	5.04		
26	C		305	260	9	84				2520			560	320	230	5.04		
28	C		305	260	9	72				2160			560	320	230	4.32		
30	C		305	260	9	72				2160			560	320	230	4.32		
32	C		305	260	9	72				2160			560	320	230	4.32		
34	C		305	260	9	60				1800			560	320	230	3.6		
36	C		305	260	9	60				1800			560	320	230	3.6		
40	C		305	260	9	60				1800			560	320	230	3.6		
44	C		305	260	9	48				1440			560	320	230	2.88		
50	C		305	260	9	48				1440			560	320	230	2.88		
60	C		305	260	9	36				1080			560	320	230	2.16		
64	C		305	260	9	36				1080			560	320	230	2.16		

	<p>◆包装方式</p> <ul style="list-style-type: none"> ◇ A= 1 → 9 ◇ B= 3 → 9 ◆ C= 4 → 9 ◇ D= 5 → 2 → 9 ◇ E= 6 → 7 → 9 ◇ F= 1 → 8 → 9 ◇ G= 3 → 1 → 9
--	--