

The product using material and processing must conform to the "WI-PZ-001"HSF technical standard control requirements

RoHS

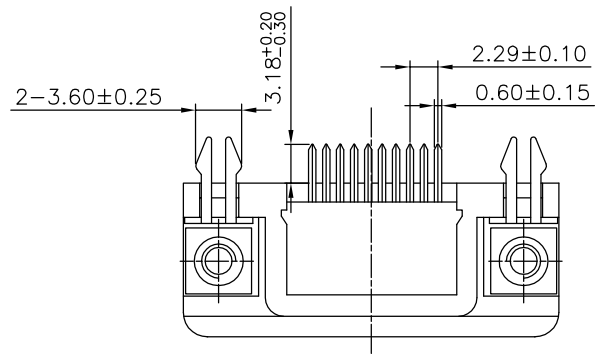
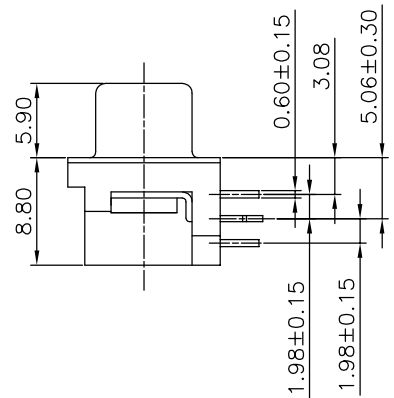
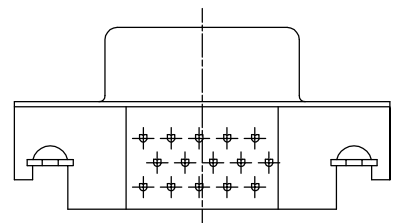
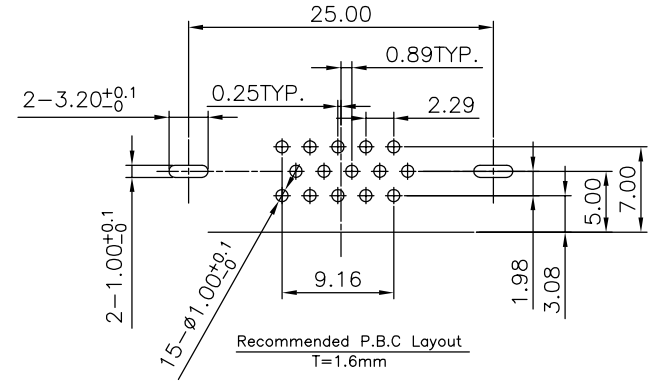
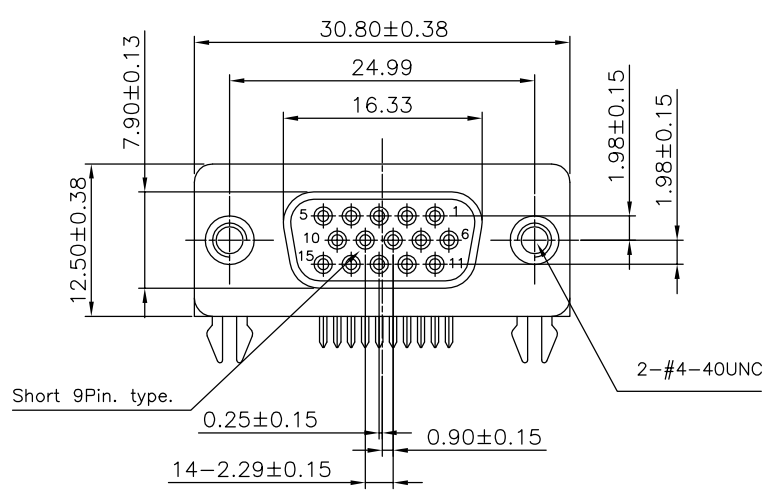

NOTE:

1. MATERIAL:

- 1.1 INSULATOR:PBT+30%GF, COLOR:BLUE
- 1.2 COVER:PBT+30%GF, COLOR:BLUE
- 1.3 CONTACT: COPPER ALLOY,
- 1.4 SHELL:SPCC
- 1.5 SQUARE RIVET:BRASS
- 1.6 GROUND HARPOON:SPCC

2. PLATING:

2.1 CONTACT:

NI 40U" MIN. UNDER PLATED OVER ALL.  
 AU GOLD FLASH PLATED ON THE FUNCTIONAL AREA OF CONTACT.

- 2.2 SHELL:NICKEL PLATED OVERALL
- 2.3 SQUARE RIVET:NICKEL PLATED OVERALL
- 2.4 GROUND HARPOON:TIN PLATED OVERALL

3. SPECIFICATIONS:

VOLTAGE: 250 VAC(RMS) MAX.  
 CURRENT RATING: 3 AMPERE PER CONTACT  
 CONTACT RESISTANCE: 30 MILLIOHMS MAX.  
 INSULATION RESISTANCE: 1000 MEGOHMS MIN.  
 DIELECTRIC WITHSTANDING VOLTAGE: 500V AC(RMS)  
 MATING FORCE: 5.1Kg.Max.  
 UNMATING FORCE: 1.0Kg.Min.  
 OPERATING TEMPERATURE:-25°C ~ +85°C

REV.	REVISION RECORD	DATE		GENERAL TOLERANCES		SCALE: 1:1	NAME	DATE	PART.NO:	DWG.NO:	
A0	NEW RELEASE	21.01.13		LINEAR	ANGLES	APPROVED	Wang_jr	21.01.13	WLDBF9-1511G0133	ENDE05	
			UNIT:mm	0.00±0.25	X'±3'	DESIGNER	Han_Gao	21.01.13	TITLE:		
			SIZE: A4	0.000±0.10	X'X' ±2'	DRAWN	Zijun_Huang	21.01.13	HDR3.08 15P FEMALE R/A DIP		

WanLian Technology Co., Ltd

REV: A0 SHEET: 1/1