

The product using material and processing must conform to the "WL-PZ-001"HSF technical standard control requirements

RoHS

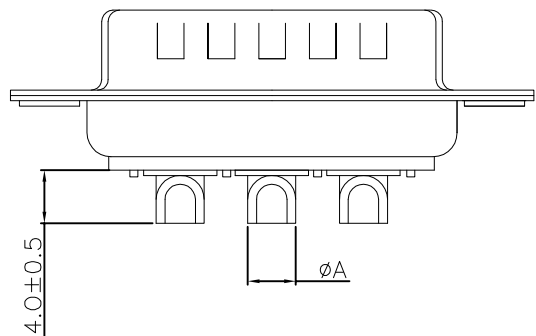
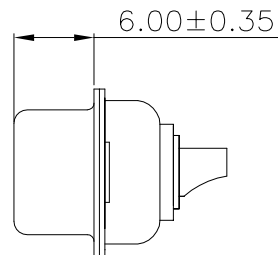
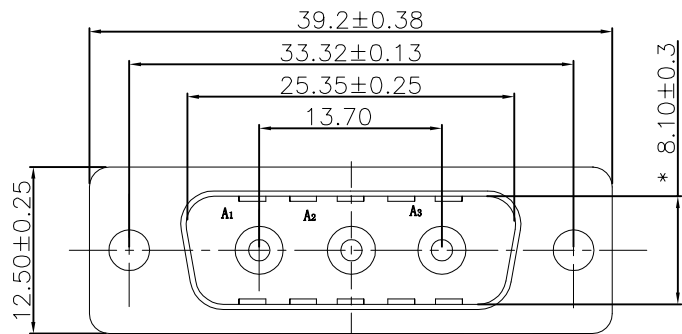

NOTE:

1.MATERIALS AND FINISH

1-1 SHELL: STEEL OR COPPER ALLOY MATERIAL, Tin/Ni OR Au FINISHED.

1-2 CONNECTOR INSULATOR: PBT THERMOPLASTIC,BLACK, 30% GLASS FILLED,UL 94V-0 RATED.

1-3 HIGH POWER CONTACT: COPPER ALLOY MATERIAL, GOLD PLATED.

2.ELECTRICAL CHARACTERISTICS

2-1 HIGH POWER CONTACT CURRENT RATING: 10,20,30 AMPS.

2-2 THE WORKING VOLTAGE: 300V.

2-3 HIGH POWER CONTACT RESISTANCE: 2.7 MILLIOHMS MAX.

2-4 DIELECTRIC WITHSTANDING VOLTAGE: 1000 V AC FOR 1 MINUTE.

2-5 INSULATION RESISTANCE: 2000 MEGAOHMS MIN.

3.TEMPERATURE RATING: -55°~+125°.

4.P/N:

P/N	A	WIRE	CURRENT RATING
WLDBM0-034AA1192	2.5	12#	10A
WLDBM0-034AA2192	3.6	10#	20A
WLDBM0-034AA3192	4.4	8#	30A
WLDBM0-034AA4192	5.5	6#	40A

REV.	REVISION RECORD	DATE		GENERAL TOLERANCES		SCALE: 1:1	NAME	DATE	PART.NO: WLDBM0-034AAX192	DWG.NO: ENDE05	 WanLian Technology Co., Ltd	
AO	NEW RELEASE	22.10.28		LINEAR	ANGLES	APPROVED	Wang_jr	22.10.28				
			UNIT:mm	0.00±0.25	X'±3'	DESIGNER	Han_Gao	22.10.28	TITLE: 3W3 公 电流短体焊线式传统铆合			REV: A0
			SIZE: A4	0.000±0.10	X'X' ±2'	DRAWN	LanXuan_Hou	22.10.28				