

The product using material and processing must conform to the "WL-PZ-001" HSF technical standard control requirements

RoHS

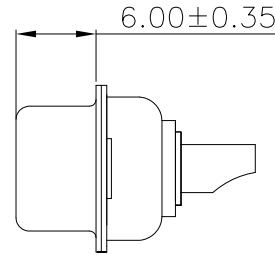
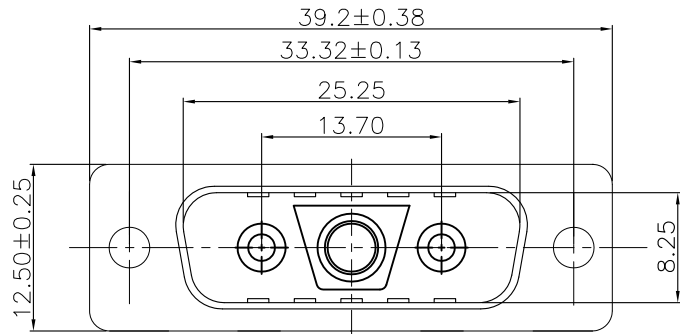

NOTE:

1. MATERIALS AND FINISH

- 1-1 SHELL: SPCC-SD Tin/Ni FINISHED.
- 1-2 CONNECTOR INSULATOR: PBT THERMOPLASTIC, BLACK, 30% GLASS FILLED, UL 94V-0 RATED.
- 1-3 HIGH POWER CONTACT: COPPER ALLOY MATERIAL, GOLD PLATED.

2. ELECTRICAL CHARACTERISTICS

- 2-1 HIGH POWER CONTACT CURRENT RATING: 10, 20, 30 OR 40 AMPS.
- 2-2 THE WORKING VOLTAGE: 300V.
- 2-3 HIGH POWER CONTACT RESISTANCE: 20 MILLIOHMS MAX.
- 2-4 DIELECTRIC WITHSTANDING VOLTAGE: 1000 V AC FOR 1 MINUTE.
- 2-5 INSULATION RESISTANCE: 2000 MEGAOHMS MIN.

3. TEMPERATURE RATING: -55°~+125°.

4. P/N:

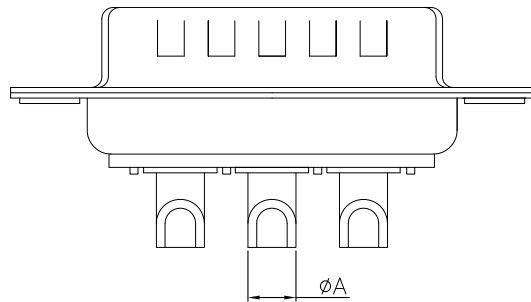

P/N	A	WIRE	CURRENT RATING
WLDBM0-034AA1216	2.5	12#	10A
WLDBM0-034AA2216	3.6	10#	20A
WLDBM0-034AA3216	4.4	8#	30A
WLDBM0-034AA4216	5.5	6#	40A

REV.	REVISION RECORD	DATE		GENERAL TOLERANCES		SCALE: 1:1	NAME	DATE	PART NO: WLDBM0-034AAX216	DWG. NO: ENDE05	 WanLian Technology Co., Ltd	
AO	NEW RELEASE	22.10.28		LINEAR	ANGLES	APPROVED	Wang_jr	22.10.28				
			UNIT:mm	0.00±0.25	X°±3°	DESIGNER	Han_Gao	22.10.28	TITLE: 3V3 公 大电流短体焊线式传统铆合			REV: A0
			SIZE: A4	0.000±0.10	X°X' ±2°	DRAWN	LanXuan_Hou	22.10.28				