

The product using material and processing must conform to the "WI-PZ-001"HSF technical standard control requirements

RoHS

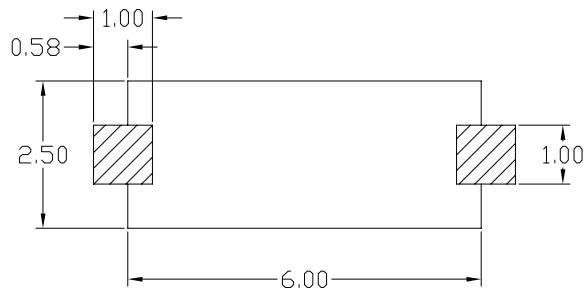

RECOMMENDED PCB LAYOUT
TOLERANCE: ±0.05

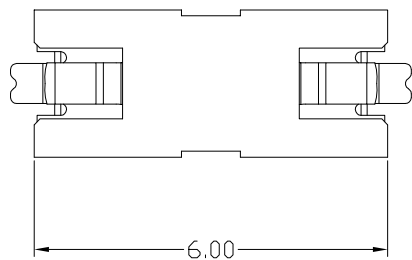
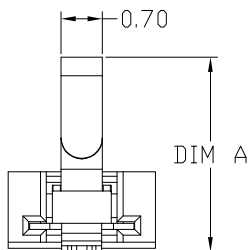
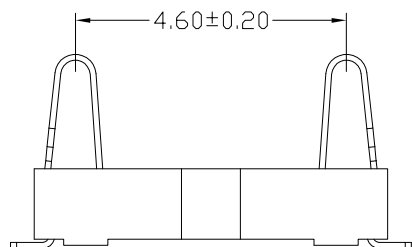
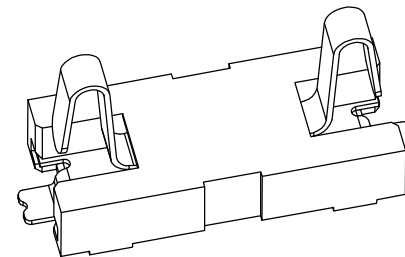

NOTE:

- 1.MATERIAL SPECIFICATION:
1-1.HOUSING:HIGH TEMPRATURE ,UL 94V-0,
1-2.CONTACTS:COPPER ALLOY.
- 2.PLATING SPECIFICATION:
2-1.CONTACTS:
Ni 50u" MIN. UNDER PLATED OVER ALL.
Au PLATED ON THE FUNCTIONAL AREA OF CONTACT.
- 3.ELECTRICAL PERFORMANCE:
3-1.CURRENT RATING:0.5A
3-2.VOLTAGE RATING:12V
3-3.CONTACT RESISTANCE: 30m Ohm MAX.
3-4.INSULATION RESISTANCE: 100MΩ MIN
3-5.DIELECTRIC WITHSTANDING VOLTAGE: 500V AC MIN.
- 4.ENVIRONMENTAL PERFORMANCE:
OPERATING TEMPERATURE: -20°C~+85°C.

WLBTF0-02 2 X X X 007

PLATING:
 1-G/F
 2-AU 3U"
 5-AU 15U"
 6-AU 30U"
 COLOUR:
 K:White

1:DIN A=2.00
 2:DIN A=2.50
 3:DIN A=3.20
 4:DIN A=3.50
 5:DIN A=3.80
 6:DIN A=4.00
 7:DIN A=4.70

REV.	REVISION RECORD	DATE		GENERAL TOLERANCES		SCALE: 1:1	NAME	DATE	PART.NO:	DWG.NO:	
AO	NEW RELEASE	21.01.13		LINEAR	ANGLES	APPROVED	Wang_jr	21.01.13	WLBTF0-022XXX007	ENDE05	
			UNIT:mm	0.00±0.25	X'±3'	DESIGNER	Ding_bo	21.01.13	TITLE:		REV: A0 SHEET: 1/1
			SIZE: A4	0.000±0.10	X'X' ±2'	DRAWN	Ou_jian	21.01.13	1代2P BATTERY PH4.6 (H2.0~4.7)		