

The product using material and processing must conform to the "WI-PZ-001" HSF technical standard control requirements

RoHS

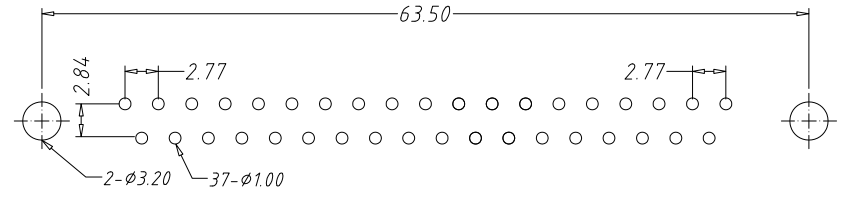
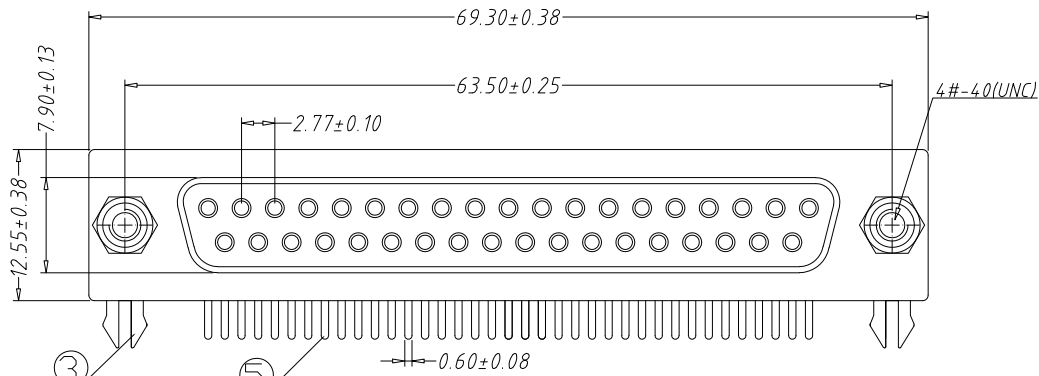

PCB LAYOUT

NOTE:
 1.ELECTRICAL PERFORMANCE:
 1-1.CURRENT RATING:1.5A
 1-2.VOLTAGE RATING:AC 1000/60ses.r.m.s.
 1-3.CONTACT RESISTANCE: 30mΩ MAX.
 1-4.INSULATION RESISTANCE: 3000MΩ MIN
 1-5.DIELECTRIC WITHSTANDING VOLTAGE: 500V AC MIN.
 2.ENVIRONMENTAL PERFORMANCE:
 OPERATING TEMPERATURE: -40°C~+85°C.

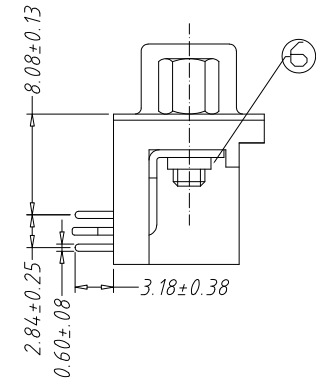
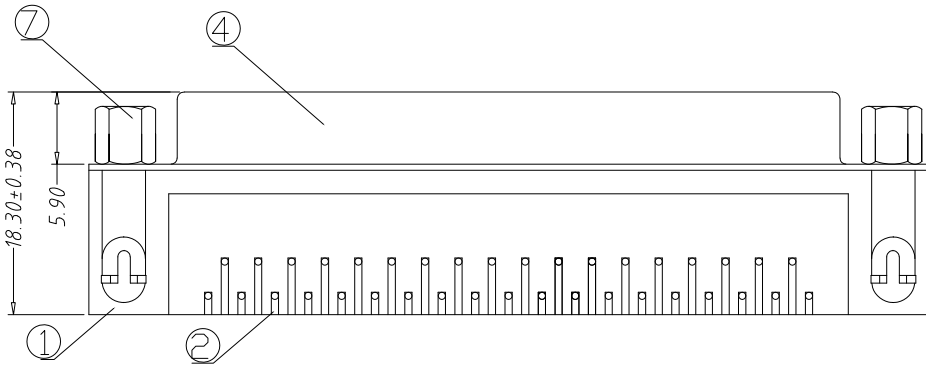

WLDBF9-37 1 X X 0082

PLATING:
 1-G/F
 2-AU 3U"
 5-AU 15U"
 6-AU 30U"
 COLOUR:
 A:Black
 K:White

MATERIALS AND FINISH

1	INSULATOR	PBT+G.F	UL94V-0
2	INSULATOR	PBT+G.F	UL94V-0
3	Board lock	BRASS	TIN FINISHED
4	SHEEL	SPCC	NICKEL FINISHED
5	CONTACT	BRASS	<small>GOLD PLATING AT CONTACT AREA, OR ALUMINUM BRIST AT TAIL, OVER 100% COVERAGE.</small>
6	RIVET	BRASS	NICKEL FINISHED
7	SCREW	BRASS	NICKEL FINISHED

REV.	REVISION RECORD	DATE		GENERAL TOLERANCES		SCALE: 1:1	NAME	DATE	PART.NO:	DWG.NO:	
A0	NEW RELEASE	21.01.13		LINEAR	ANGLES	APPROVED	Wang_jr	21.01.13	WLDBF9-371XX0082	ENDE05	
			0.0±0.35	X'REF±6°	DESIGNER	Ding_bo	21.01.13	TITLE:		REV: A0 SHEET: 1/1	
			UNIT:mm	X'±3°	DRAWN	Ou_jian	21.01.13	D-SUB DR 8.08 37F 90°DIP			
			SIZE: A4	0.000±0.10	X'X' ±2°						