

The product using material and processing must conform to the "WL-PZ-001"HSF technical standard control requirements

RoHS

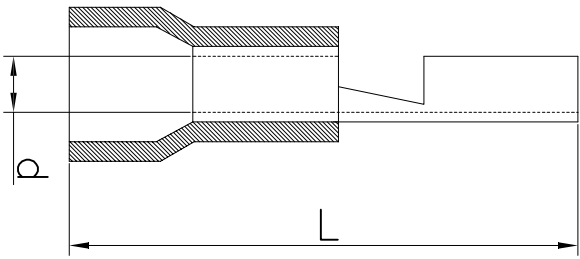
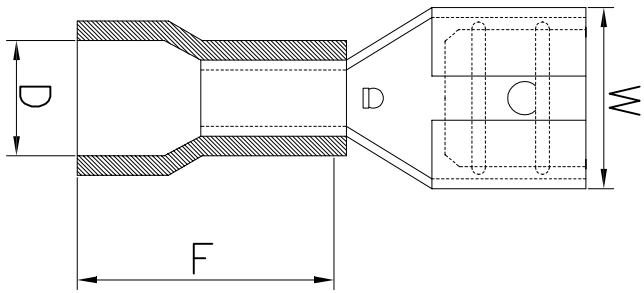

- 备注:
1. 接压线径: 0.5-1.5mm² (#22-16AWG)
 2. 端子材质: 黄铜
 3. 绝缘材质: 尼龙 绝缘护套温度: 105℃ 绝缘护套颜色: 红色
 4. 表面处理: 镀锡 镀层厚度: 2.5um-5um 镀层温度: 120° /2小时
 5. 接线类型: 绞合线
 6. 最大电流: 10A

ItemNo.料号	接插规格 Connecting spec	材料厚度 Thickness(mm)	Dimension(mm/inch)主要尺寸				
WLLD2F4-AA203CA03	0.5*4.75	0.4	D±0.2	D±0.3	F±0.3	L±0.5	W±0.2
WLLD2F4-AA203CA04	0.8*4.75		1.7	4.1	11.0	19.0	5.6
			1.7	4.1	11.0	19.0	5.6

REV.	REVISION RECORD	DATE	GENERAL TOLERANCES		SCALE:	NAME	DATE	PART NO:	DWG. NO:	REV: A0	
AO	NEW RELEASE	21.11.17	LINEAR	ANGLES	1:1	Wang_jr	21.11.17	WLLD2F4-AX203XXXX	ENDE05	SHEET: 1/1	
			0.0±0.35	X°REF±6°	APPROVED	Han_Gao	21.11.17	TITLE: 尼龙绝缘护套母插端子		Wanlian Technology Co., Ltd	
			UNIT:mm	X°±3°	DESIGNER	Zijun_Huang	21.11.17			REV: A0	
			SIZE: A4	0.000±0.10	DRAWN					SHEET: 1/1	