

The product using material and processing must conform to the "WL-PZ-001"HSF technical standard control requirements

RoHS

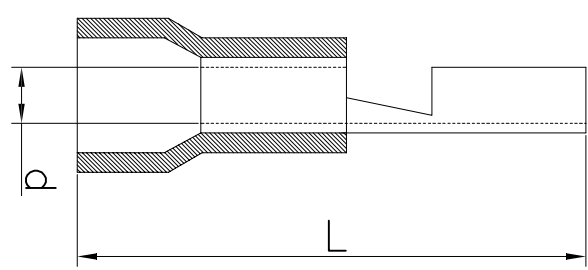
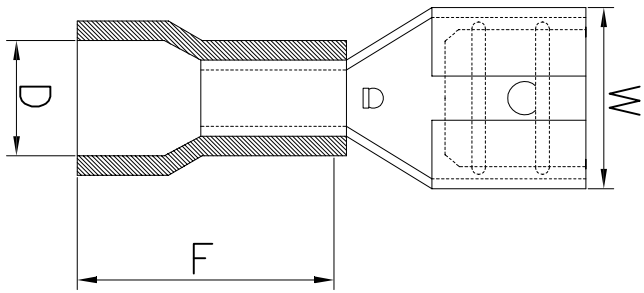

- 备注:
1. 接压线径: 0.5-1.5mm<sup>2</sup> (#22-16AWG)
  2. 端子材质: 黄铜
  3. 绝缘材质: 尼龙 绝缘护套温度: 105℃ 绝缘护套颜色: 红色
  4. 表面处理: 镀锡 镀层厚度: 2.5um-5um 镀层温度: 120° /2小时
  5. 接线类型: 绞合线
  6. 最大电流: 10A

ItemNo.料号	连接规格	材料厚度	Dimension(mm/inch)主要尺寸				
WLLF2F4-AA203CA02	0.8*6.35	0.4	D±0.2	D±0.3	F±0.3	L±0.5	W±0.2

REV.	REVISION RECORD	DATE	GENERAL TOLERANCES		SCALE:	
AO	NEW RELEASE	21.11.17	LINEAR	ANGLES	1:1	NAME
			0.0±0.35	X'REF±6°	APPROVED	DATE
			UNIT:mm	X'±3°	DESIGNER	
			SIZE: A4	X'X' ±2°	DRAWN	

WLLF2F4-AA203CA02	WLLF2F4-XX203XXXX	DWG.NO:	ENDE05		 万连科技 Wanlian Technology Co., Ltd
Wang_jr	21.11.17	TITLE:		REV: AO	
Han_Gao	21.11.17	尼龙绝缘护套母插端子		SHEET: 1/1	
Zijun_Huang	21.11.17				