

The product using material and processing must conform to the "WL-PZ-001" HSF technical standard control requirements

RoHS

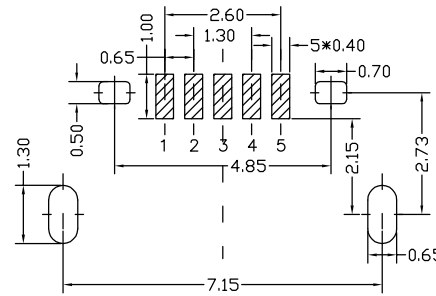
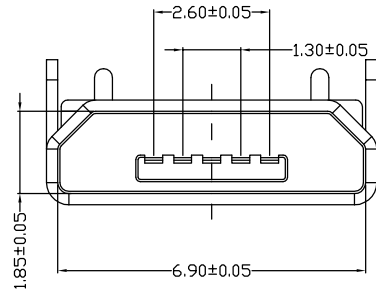

RECOMMENDED PCB LAYOUT

NOTE:

- 1.MATERIAL SPECIFICATION:
 - 1-1.HOUSING:LCP BLACK UL94V-0
 - 1-2.CONTACTS:COPPER ALLOY.
 - 1-3.SHELL: STAINLESS STEEL.
- 2.PLATING SPECIFICATION:
 - 2-1.CONTACTS:
 - Ni 50u" MIN. UNDER PLATED OVER ALL.
 - Au PLATED ON THE FUNCTIONAL AREA OF CONTACT.
 - 2-2. SHELL:
 - Ni OR SN UNDER PLATED OVER ALL.
- 3.MECHANICAL PERFORMANCE:
 - 3-1.INSERTION FORCE: 3.57kgf MAX
 - 3-2.REMOVAL FORCE: 0.8kgf MIN
 - 3-3.DURABILITY: 10000 CYCLES.
- 4.ELECTRICAL PERFORMANCE:
 - 4-1.CURRENT RATING:1.5A
 - 4-2.VOLTAGE RATING:5V MAX
 - 4-3.CONTACT RESISTANCE: 30m Ohm MAX.
 - 4-4.INSULATION RESISTANCE: 100MΩ MIN
 - 4-5.DIELECTRIC WITHSTANDING VOLTAGE: 100V AC MIN
- 5.ENVIRONMENTAL PERFORMANCE:
 - OPERATING TEMPERATURE: -30°C~+85°C.
- 6.PACKAGE SPEC: REEL

PART NO.:

WLM2F9-05 2 X X X 081

PLATING:	1-G/F	2-Au 3u"	5-Au 15u"	6-Au 30u"	SHELL:	7-SN	9-NI	COLOUR:	A-BLACK
----------	-------	----------	-----------	-----------	--------	------	------	---------	---------

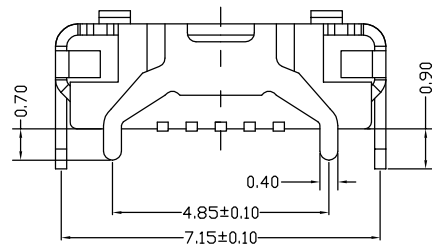
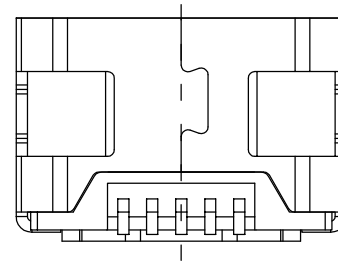
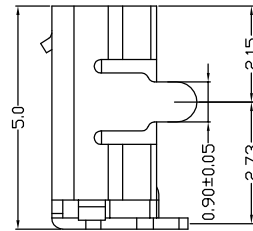
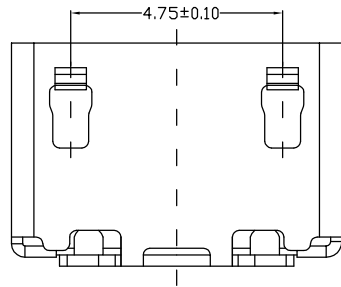

REV.	REVISION RECORD	DATE	UNIT:mm	GENERAL TOLERANCES		SCALE:	NAME	DATE	PART.NO:	DWG.NO:	WanLian Teconology Co., Ltd
A0	NEW RELEASE	21.01.13		0.00±0.25	X'±3'	1:1	Wang_jr	21.01.13	WLM2F9-052XXX081	ENDE05	
			0.00±0.10	X'X' ±2'	APPROVED	Ding_bo	21.01.13	TITLE: MICRO 5P/F B TYPE R/A 0.9(7.15*4.85)	REV: A0	SHEET: 1/1	
			0.00±0.35	X*REF±6'	DESIGNER	Ou_jian	21.01.13				
			0.00±0.10	X'X' ±2'	DRAWN						

