

The product using material and processing must conform to the "WI-PZ-001"HSF technical standard control requirements

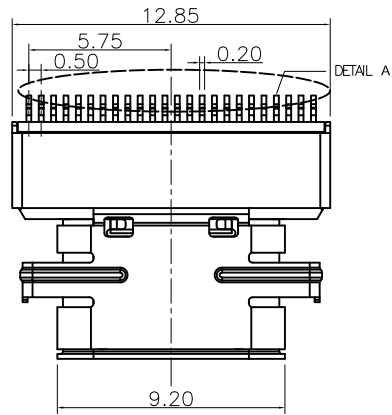

DETAIL A SCALE 2:1

PIN	A1	A2	A3	A4	A5	A6	A7	A8	A9	A10	A11	A12	SHELL
Signal Name	GND	SSTXp1	SSTXn1	VBUS	CC1	Dp1	Dn1	SBU1	VBUS	SSRXn2	SSRXp2	GND	GND
PIN	B12	B11	B10	B9	B8	B7	B6	B5	B4	B3	B2	B1	SHELL
Signal Name	GND	SSRXp1	SSRXn1	VBUS	SBU2	Dn2	Dp2	CC2	VBUS	SSTXn2	SSTXp2	GND	GND

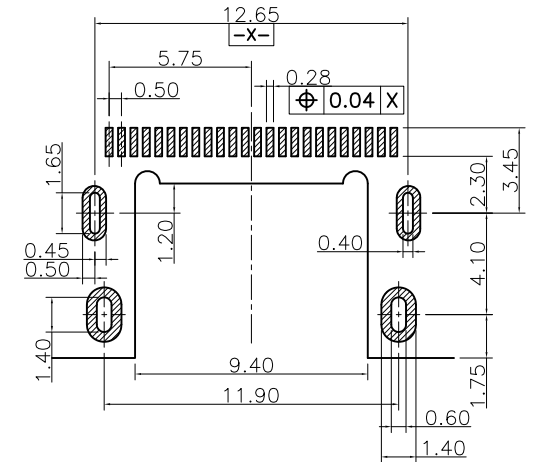

RECOMMEND P.C.B LAYOUT (THICKNESS 1.6mm)
(COMPONENT SIDE) TOLERANCE±0.03mm

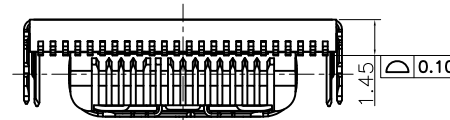
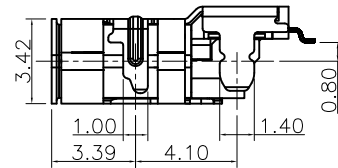
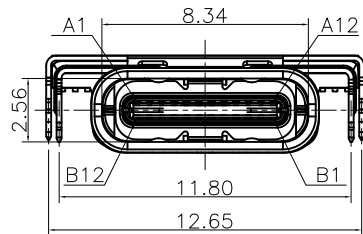

NOTE:
 1.MATERIAL SPECIFICATION:
 1-1.HOUSING:LCP BLACK UL94 V-0
 1-2.CONTACTS:COPPER ALLOY
 1-3.MID PLATE: STAINLESS STEEL
 1-4.SHELL: STAINLESS STEEL
 2.PLATING SPECIFICATION:
 2-1.CONTACTS:
 Ni UNDER PLATED OVER ALL.
 Au PLATED ON THE FUNCTIONAL AREA OF CONTACT.
 2-2.MID PLATE:
 CLEAR ONLY
 2-3.FRONT SHELL:
 Ni UNDER PLATED OVER ALL.
 3.MECHANICAL PERFORMANCE:
 3-1.INSERTION FORCE: 0.5~2.0kgf.
 3-2.REMOVAL FORCE: 0.8kgf~2.0kgf.
 3-3.DURABILITY: 10000 CYCLES.
 4.ELECTRICAL PERFORMANCE:
 4-1. CURRENT RATING:3.0A
 VOLTAGE RATING:20V MAX
 4-2. LLCR:
 VBUS & GND PINS AND OTHER PINS: 40mΩ/PIN MAX.
 SHIELD: 50mΩ/MAX.
 LLCR MAX. CHANGE OF ALL PINS: 10mΩ.
 4-3.INSULATION RESISTANCE: 100MΩ MIN
 4-4.WITHSTANDING VOLTAGE: 100V AC R.M.S.
 5.ENVIRONMENTAL PERFORMANCE:
 OPERATING TEMPERATURE: -25°C~+85°C.

WLT4F9-24 8 X X X 06-085

PLATING:
 1-G/F
 2-Au 3u"
 5-Au 15u"
 6-Au 30u"
 SHELL:
 9-NI
 COLOUR:
 A-BLACK
 K-WHITE
 H-PURPLE

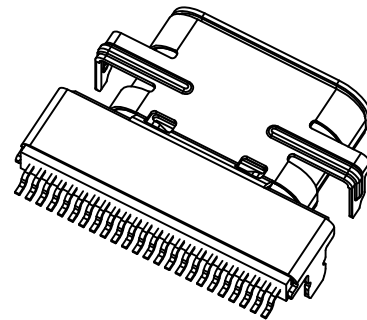
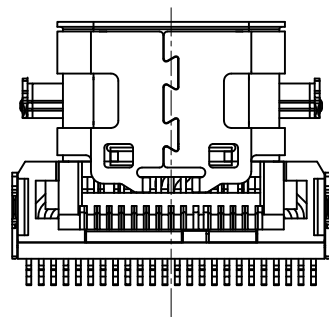

REV.	REVISION RECORD	DATE		GENERAL TOLERANCES		SCALE: 1:1	NAME	DATE	PART.NO:	DWG.NO:	 WanLian Teconology Co., Ltd
A0	NEW RELEASE	21.01.13		LINEAR	ANGLES	APPROVED	Wang_jr	21.01.13	WLT4F9-248XXX06-085	ENDE05	
			UNIT:mm	0.00±0.25	X°±3°	DESIGNER	Han_Gao	21.01.13	TITLE:		
			SIZE: A4	0.000±0.10	X°X' ±2°	DRAWN	Zijun_Huang	21.01.13	USB 3.1 TYPE C CONN. CH-0.80		REV: A0 SHEET: 1/1