

The product using material and processing must conform to the "WL-PZ-001"HSF technical standard control requirements

RoHS

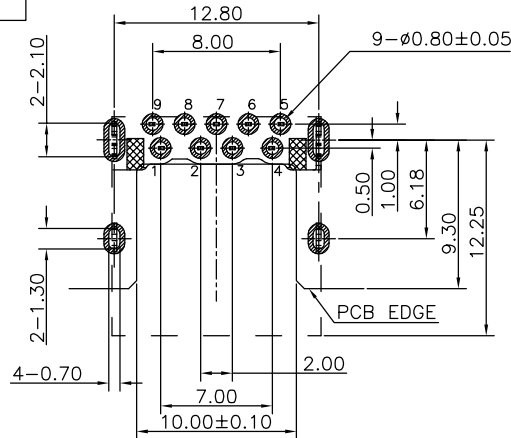
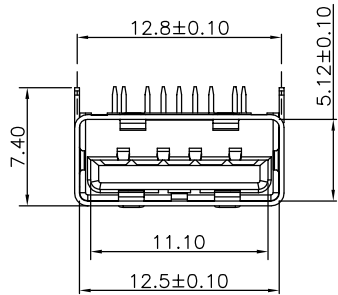

TOLERANCE: ± 0.05 , THICKNESS: 1.0mm
RECOMMENDED PCB LAYOUT
 (TOP VIEW)
 KEEP OUT AREA

NOTE:

- 1.MATERIAL SPECIFICATION:
 - 1-1.HOUSING:LCP BLUE UL94V-0
 - 1-2.CONTACTS:C2680.
 - 1-3.SHELL:STAINLESS STEEL.
- 2.PLATING SPECIFICATION:
 - 2-1.CONTACTS:
Ni 50u" MIN. UNDER PLATED OVER ALL.
Sn 80u"MIN ON SOLDER AREA
Au PLATED ON THE CONTACTS AREA.
 - 2-2. SHELL:
Ni 80u" MIN. UNDER PLATED OVER ALL.
- 3.MECHANICAL PERFORMANCE:
 - 3-1.INSERTION FORCE: 3.57kgf MAX
 - 3-2.REMOVAL FORCE: 1.02kgf MIN
 - 3-3.DURABILITY: 5000 CYCLES.
- 4.ELECTRICAL PERFORMANCE:
 - 4-1.CURRENT RATING:1.5A
 - 4-2.VOLTAGE RATING:30V MAX
 - 4-3.CONTACT RESISTANCE: 30mΩ MAX.
 - 4-4.INSULATION RESISTANCE: 1000MΩ MIN
 - 4-5.DIELECTRIC WITHSTANDING VOLTAGE: 100V AC MIN.
- 5.ENVIRONMENTAL PERFORMANCE:
OPERATING TEMPERATURE: $-40^{\circ}\text{C}\sim+85^{\circ}\text{C}$.
- 6.PACKAGE SPEC: TRAY
- 7.P/N ORDER:

WLU3F9-09 1 X X X 114

PLATING: _____ SHELL:
 1-G/F 1-SPCC
 2-Au 3u" 2-COPPER ALLOY
 5-Au 15u" 3-SUS
 6-Au 30u" _____ HOUSING COLOUR:
 A-BLACK
 G-BLUE

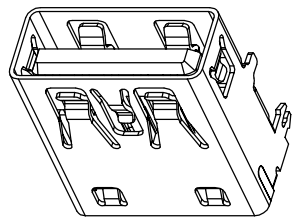
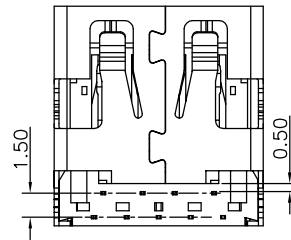
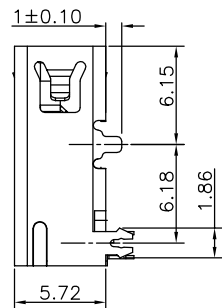
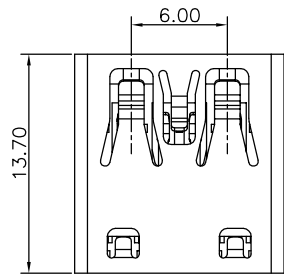

Pin #	SIGNAL NAME	DESCRIPTION	MATING SEQUENCE
1	VBUS	POWER	SECOND
2	D-	USB 2.0 DIFFERENTIAL PAIR	THIRD
3	D+		
4	GND	GROUND FOR POWER RETURN	SECOND
5	StdA_SSRX-	SUPER SPEED RECEIVER DIFFERENTIAL PAIR	LAST
6	StdA_SSRX+		
7	GND_DRAIN	GROUND FOR SIGNAL RETURN	
8	StdA_SSTX-	SUPER SPEED TRANSMITTER DIFFERENTIAL PAIR	FRIST
9	StdA_SSTX+		
Shell	Shield	CONNECTOR METAL SHELL	

REV.	REVISION RECORD	DATE	GENERAL TOLERANCES		SCALE:	NAME	DATE	PART.NO:	DWG.NO:	 WanLian Teconology Co., Ltd	
A0	NEW RELEASE	21.01.13	LINEAR	ANGLES	1:1	APPROVED	Wang_jr	21.01.13	WLU3F9-091XXX114		ENDE05
			0.0±0.35	X°REF±6°		DESIGNER	Han_Gao	21.01.13	TITLE: USB3.0 A TYPE 9P/F DIP		REV: A0
			0.00±0.25	X°±3°		DRAWN	Zijun_Huang	21.01.13			SHEET: 1/1
			UNIT:mm	0.00±0.10	X°X'±2°						