

The product using material and processing must conform to the "WL-PZ-001" HSF technical standard control requirements

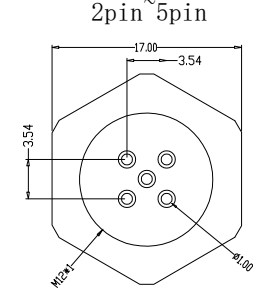

Recommended Panel Cut-out

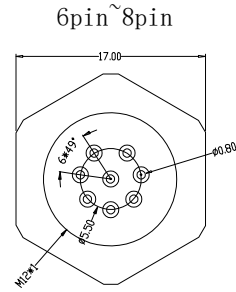
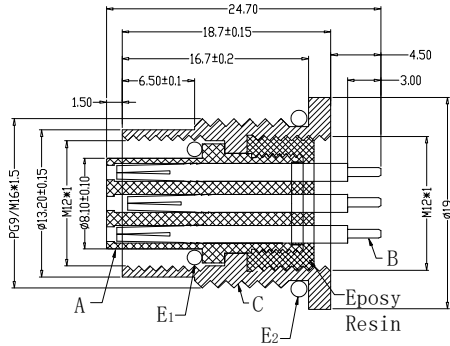
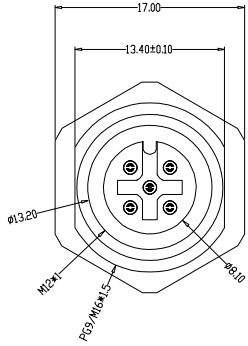
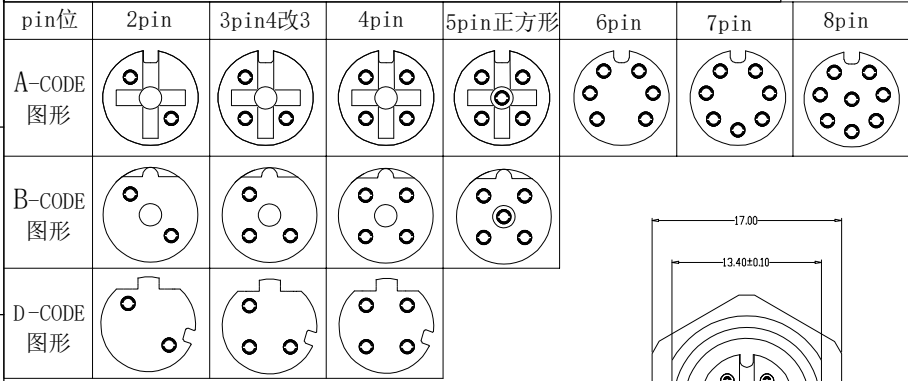
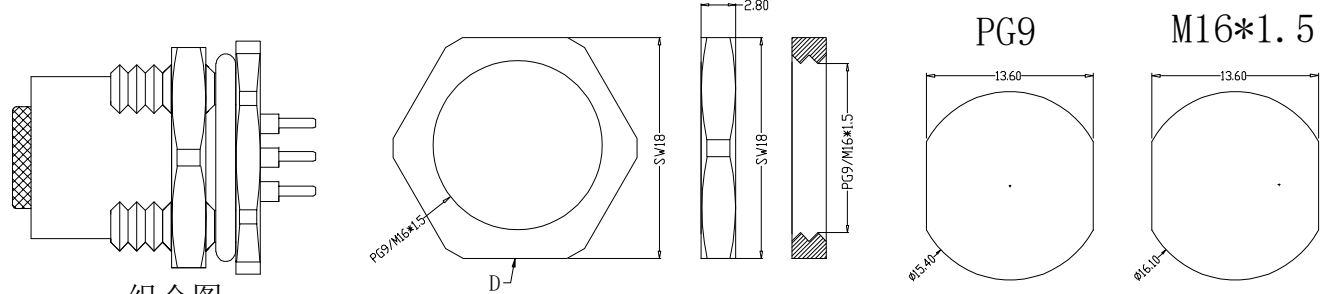

P/N	TITLE
M12A02-04-089	M12防水 A-CODE 2P板端母头 前锁面板式 PG9/M16 SW17T/24L
M12A03-04-089	M12防水 A-CODE 3P板端母头 前锁面板式 PG9/M16 SW17T/24L
M12A04-04-089	M12防水 A-CODE 4P板端母头 前锁面板式 PG9/M16 SW17T/24L
M12A05-04-089	M12防水 A-CODE 5P板端母头 前锁面板式 PG9/M16 SW17T/24L
M12A06-04-089	M12防水 A-CODE 6P板端母头 前锁面板式 PG9/M16 SW17T/24L
M12A07-04-089	M12防水 A-CODE 7P板端母头 前锁面板式 PG9/M16 SW17T/24L
M12A08-04-089	M12防水 A-CODE 8P板端母头 前锁面板式 PG9/M16 SW17T/24L
M12B02-04-089	M12防水 B-CODE 2P板端母头 前锁面板式 PG9/M16 SW17T/24L
M12B03-04-089	M12防水 B-CODE 3P板端母头 前锁面板式 PG9/M16 SW17T/24L
M12B04-04-089	M12防水 B-CODE 4P板端母头 前锁面板式 PG9/M16 SW17T/24L
M12B05-04-089	M12防水 B-CODE 5P板端母头 前锁面板式 PG9/M16 SW17T/24L
M12D02-04-089	M12防水 D-CODE 2P板端母头 前锁面板式 PG9/M16 SW17T/24L
M12D03-04-089	M12防水 D-CODE 3P板端母头 前锁面板式 PG9/M16 SW17T/24L
M12D04-04-089	M12防水 D-CODE 4P板端母头 前锁面板式 PG9/M16 SW17T/24L

Engagement force	≤50N	Rated voltage	2-5pin:60v 6-8PIN:30V	PARTS	MARERIALS	TREATMENT	AMOUNT
Disengagement force	≥5N	Rated current	2-5pin:4A 6-8PIN:2A	A	HOUSING	PA66+GF	SPECIFY COLOR 1
Mechanical lifespan	≥500	Insulation resistance	1000MΩ	B	CONTACT	BRASS	GOLD PLATED 2~8
IP rating	IP67/IP68	Conract resistangce	≤10MΩ	C	OUTER CONTACT	BRASS	NICKL PLATED 1
Flammability	UL94 V-0	Operation Temperature	-40° C~105° C	D	NUT	BRASS	NICKL PLATED 1
				E	O-RING	EPDM	BLACK 2

REV.	REVISION RECORD	DATE		GENERAL TOLERANCES		SCALE:	NAME	DATE	PART.NO:	DWG.NO:	 WanLian Technology Co., Ltd
A0	NEW RELEASE	21.11.17		LINEAR	ANGLES	1:1					
				0.0±0.35	X'REF±6°	APPROVED					
				UNIT:mm	0.00±0.25	X'±3°					
			SIZE: A4	0.000±0.10	X'X' ±2'	DRAWN			M12XXX-04-089	ENDE05	
TITLE:										M12 板端母头 A-CODE 前锁面板式PG9/M16 SW17T24.7L	
										REV: A0	SHEET: 1/1