

The product using material and processing must conform to the "WL-PZ-001"HSF technical standard control requirements

RoHS

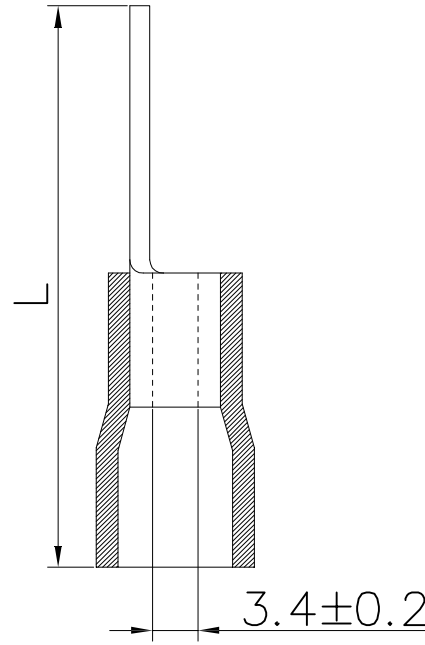
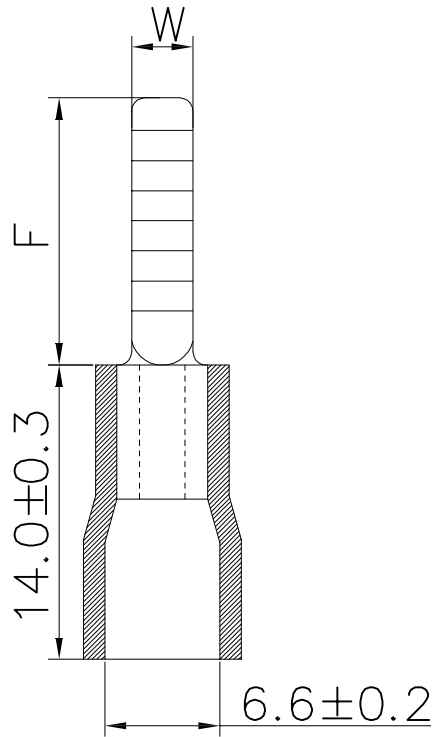

备注:

1. 接压线径: 4-6mm² (12-10AWG)
2. 端子材质: 紫铜 厚度: 1.0 ± 0.05
3. 绝缘材质: 尼龙 绝缘护套温度: 105°C 绝缘护套颜色: 黄色
4. 表面处理: 镀锡 镀层厚度: 2.5um-5um 镀层温度: 120° /2小时
5. 接线类型: 实心或绞合线
6. 最大电流: 48A

ItemNO.料号	mm/inch主要尺寸		
	W	L	F
WLLA12-000AD03EA17	2.8 ± 0.2	24.0 ± 0.3	10.0 ± 0.3
WLLA12-000AD03EA18	4.5 ± 0.2	28.0 ± 0.3	14.0 ± 0.3
WLLA12-000AD03EA19	4.5 ± 0.2	32.0 ± 0.3	18.0 ± 0.3

REV.	REVISION RECORD	DATE		GENERAL TOLERANCES		SCALE: 1:1	NAME	DATE	PART.NO:	DWG.NO:	
A0	NEW RELEASE	21.11.17			LINEAR	ANGLES	APPROVED	Wang_jr	21.11.17	WLLA12-000AD03EXXX	
			UNIT:mm	0.00 ± 0.25	$X' \pm 3'$	DESIGNER	Han_Gao	21.11.17	TITLE:		REV: A0 SHEET: 1/1
			SIZE: A4	0.000 ± 0.10	$X'X' \pm 2'$	DRAWN	Zijun_Huang	21.11.17	尼龙绝缘护套片形端子		