

The product using material and processing must conform to the "WL-PZ-001"HSF technical standard control requirements

RoHS

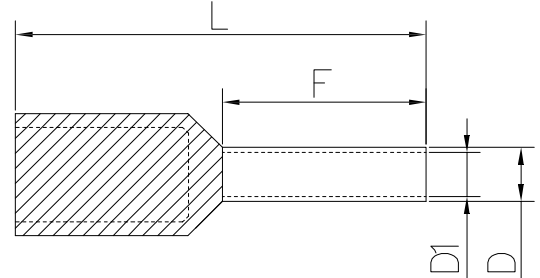
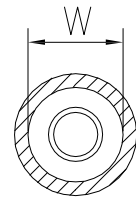

- 备注:
1. 端子材质: 紫铜, 壁厚: 0.14 ± 0.03
 2. 绝缘材质: 尼龙, 绝缘护套温度: $105^{\circ}C$, 绝缘护套颜色: 红色
 3. 表面处理: 镀雾锡, 镀层温度: 120° /2小时
 4. 接线类型: 绞合线

料号 Item NO	导线截面Cable Size		mm/inch 主要尺寸				
	A.W.G	mm ²	D ± 0.03	D1 ± 0.03	W ± 0.25	F ± 0.3	L ± 0.3
WLLE14-000AA03CB26	#20	0.75	1.6	1.3	2.8	6.0	12.1
WLLE14-000AA03CB27						8.0	14.0
WLLE14-000AA03CB28						10.0	16.0
WLLE14-000AA03CB29						12.0	18.0

REV.	REVISION RECORD	DATE		GENERAL TOLERANCES		SCALE: 1:1	NAME	DATE	PART.NO:	DWG.NO:	 WanLian Teconology Co., Ltd
A0	NEW RELEASE	22.04.13		LINEAR	ANGLES	APPROVED	Wang_jr	22.04.13	WLLE14-000AA03CXXX	ENDE05	
			0.0 ± 0.35	X'REF $\pm 6^{\circ}$	DESIGNER	Han_Gao	22.04.13	TITLE:			
			UNIT:mm	0.00 ± 0.25	X' $\pm 3^{\circ}$	DRAWN	LanXuan_Hou	22.04.13	半绝缘尼龙绝缘护套管型端子 压线#20	REV: A0	