

The product using material and processing must conform to the "WL-PZ-001"HSF technical standard control requirements

RoHS

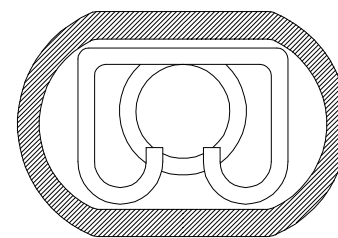
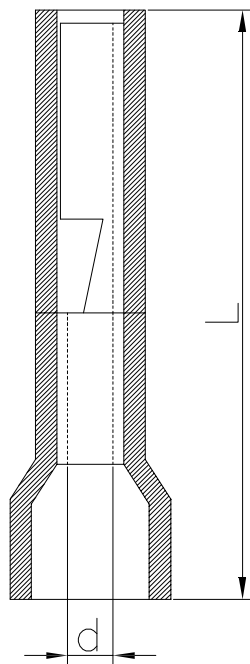
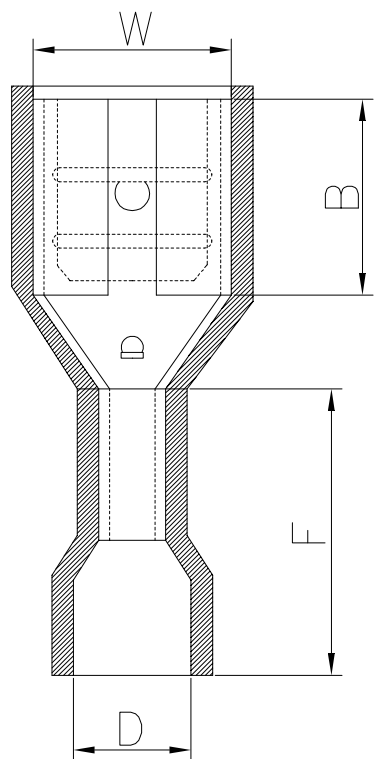

备注:

1. 接压线径: 0.5-1.5mm<sup>2</sup> (22-16AWG)
2. 端子材质: 黄铜, 厚度: 0.4±0.01
3. 绝缘材质: 尼龙, 绝缘护套温度: 105° C, 绝缘护套颜色: 红色
4. 表面处理: 镀锡, 镀层厚度: 2.5 μm-5 μm, 镀层温度: 120° /2小时
5. 接线类型: 绞合线
6. 最大电流: 10A

接插规格 Connecting spec	Dimension(mm/inch)主要尺寸					
	d±0.2	D±0.3	W±0.2	L±0.4	B±0.2	F±0.3
0.5*6.35	1.7	4.5	7.6	22.0	7.3	10.7

REV.	REVISION RECORD	DATE		GENERAL TOLERANCES		SCALE: 1:1	NAME	DATE	PART.NO:	DWG.NO:	
A0	NEW RELEASE	21.11.17		LINEAR 0.0±0.35 UNIT:mm SIZE: A4	ANGLES X°REF±6° X°±3° X°X'±2°	APPROVED	Wang_jr	21.11.17	WLLF2F2-AA203CA01	ENDE05	
					DESIGNER	Han_Gao	21.11.17	TITLE: 尼龙全绝缘250系列母插片连续端子(方口)			
					DRAWN	Zijun_Huang	21.11.17				