

The product using material and processing must conform to the "WL-PZ-001" HSF technical standard control requirements

RoHS

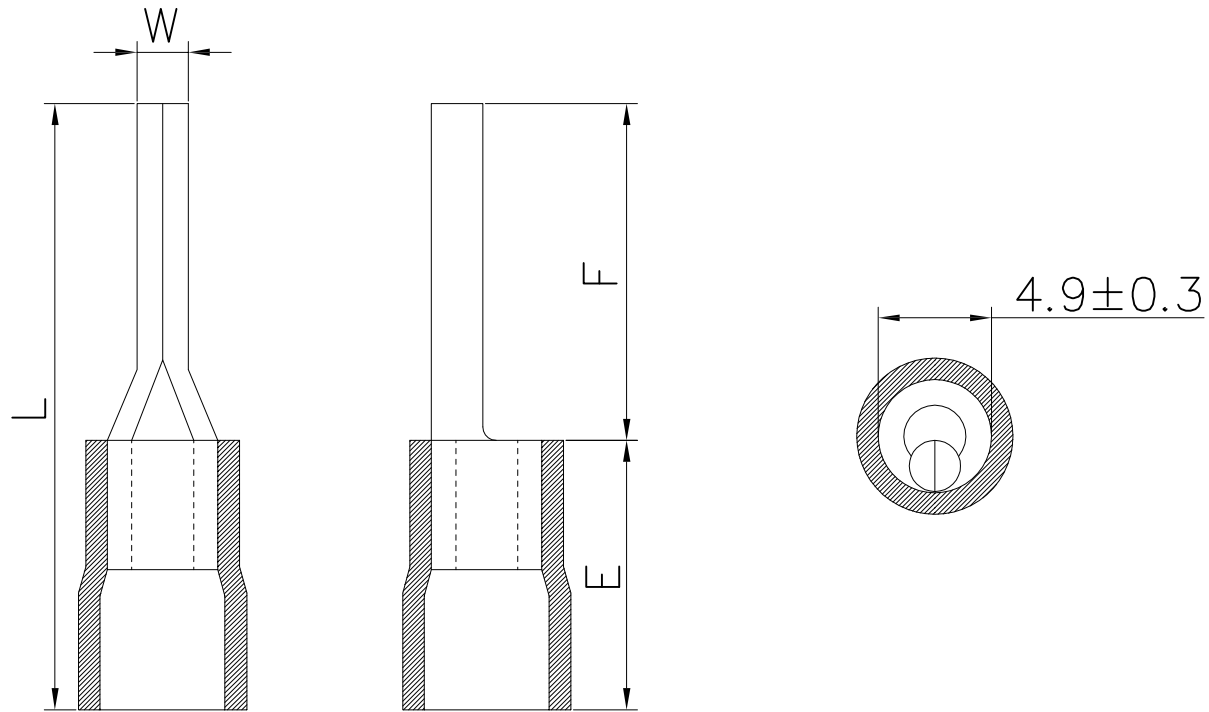

备注:

1. 接压线径: 1.5-2.5mm² (16-14A. W. G)
2. 端子材质: 紫铜 厚度: 0.8±0.03
3. 绝缘材质: PVC; 绝缘护套温度: 常温; 绝缘护套颜色: 蓝色
4. 表面处理: 镀锡 镀层厚度: 2.5um-5um 镀层温度: 120° /2小时
5. 接线类型: 绞合线
6. 最大电流: 27A

Item NO.料号	mm/inch主要尺寸			
	W	L	E	F
WLLP13-100AB03GB96	1.9±0.15	20.7±0.5	10.7±0.5	10.0±0.5
WLLP13-120AB03GB96	1.9±0.15	22.7±0.5	10.7±0.5	12.0±0.5
WLLP13-130AB03GB96	1.9±0.15	23.7±0.5	10.7±0.5	13.0±0.5
WLLP13-180AB03GB96	1.9±0.15	28.7±0.5	10.7±0.5	18.0±0.5

REV.	REVISION RECORD	DATE		GENERAL TOLERANCES		SCALE: 1:1	NAME	DATE	PART.NO:	DWG.NO:	 WanLian Teconology Co., Ltd
A0	NEW RELEASE	22.07.07		LINEAR	ANGLES	APPROVED	Wang_jr	22.07.07	WLLP13-XXXAB03GB96	ENDE05	
			0.0±0.35	X'REF±6°	DESIGNER	Han_Gao	22.07.07	TITLE:		REV: A0	SHEET: 1/1
			UNIT:mm	0.00±0.25	X'±3'	DRAWN	LanXuan_Hou	22.07.07	PVC绝缘护套针形单粒端子		
			SIZE: A4	0.000±0.10	X'X' ±2'						