

The product using material and processing must conform to the "WI-PZ-001" HSF technical standard control requirements

RoHS

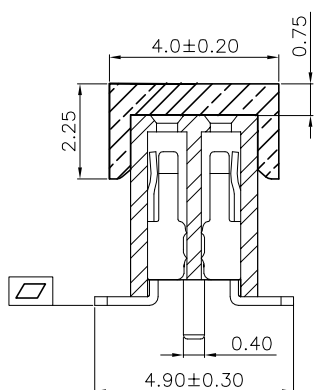

	2*3~2*15P	0.10
	2*16~2*25P	0.15
	2*26~2*40P	0.20

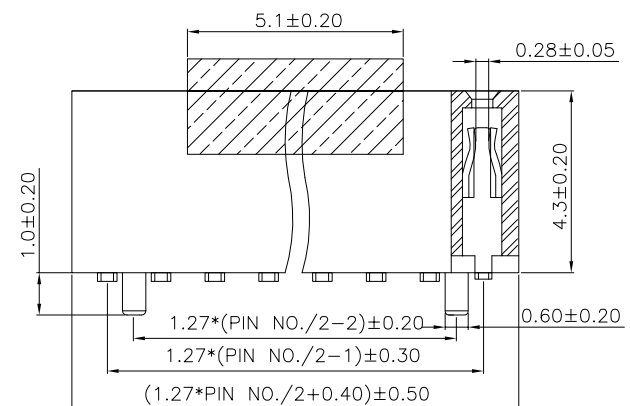
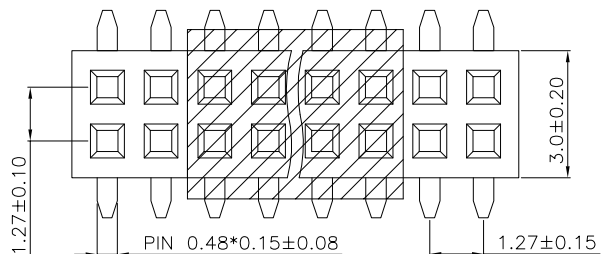
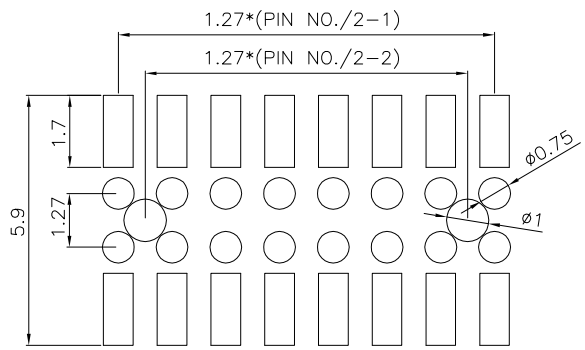

NOTE:
 1.MATERIAL SPECIFICATION:
 1-1.HOUSING: THERMOPLASTIC HIGH TEMP,UL94V-0
 1-2.CONTACTS: BRASS
 2.PLATING SPECIFICATION:
 2-1.CONTACTS:
 TIN/GOLD FLASH PLATED OVER ALL.
 3.MECHANICAL PERFORMANCE:
 3-1.RETENTIVITY FORCE: 0.2KGF/pin min
 3-2.DURABILITY: 100 CYCLES.
 4.ELECTRICAL PERFORMANCE:
 4-1.CURRENT RATING: 1A AC/DC
 RATED VOLTAGE : 300V AC/DC
 4-2.CONTACT RESISTANCE: 20 mΩ MAX
 4-3.INSULATION RESISTANCE: 1000MΩ Min
 4-4.DIELECTRIC WITHSTANDING : 300V
 5.ENVIRONMENTAL PERFORMANCE:
 5-1.OPERATING TEMPERATURE: -40°C~+105°C.
 6.PACKAGE SPEC: REEL
 7.P/N:

FH1276 43 F 0-2 XX 2 X X X 07
 SERIES NO: _____ HOUSING: 1-PA9T
 HEIGHT: _____ 43: 4.3mm COLOR: A-BLACK
 MALE FEMALE: _____ PLATING: A-ALL AU G/F
 F-FEMALE
 ANGLE: _____ 0-180°
 ROW NO: _____ 2-DOUBLE ROW
 PIN Q' PY: _____ TERMPIENT: 2-SMT
 XXPIN

REV.	REVISION RECORD	DATE		GENERAL TOLERANCES		SCALE: 1:1	NAME	DATE	PART.NO:	DWG.NO:	
AO	NEW RELEASE	22.05.09		LINEAR	ANGLES	APPROVED	Wang_jr	22.05.09	FH127643F0-2XX2XXX07	ENDE05	
			UNIT:mm	0.00±0.25	X'±3'	DESIGNER	Han_Gao	22.05.09	TITLE:		REV: A0 SHEET: 1/1
			SIZE: A4	0.000±0.10	X'X' ±2'	DRAWN	LanXuan_Hou	22.05.09	Pitch 1.27mm 180° 双排 SMT+CAP带定位排母H4.3		