

The product using material and processing must conform to the "WI-PZ-001" HSF technical standard control requirements

RoHS

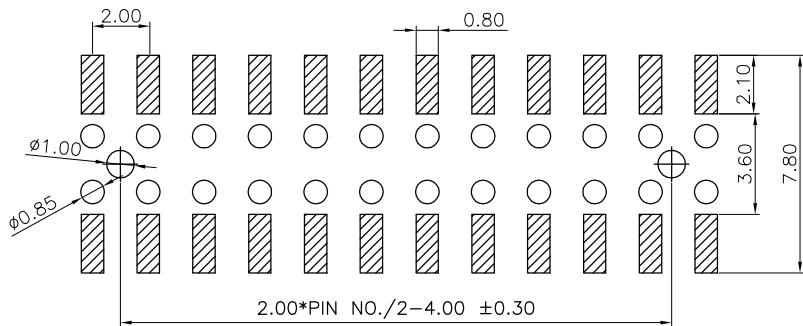
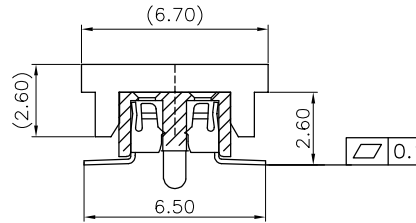
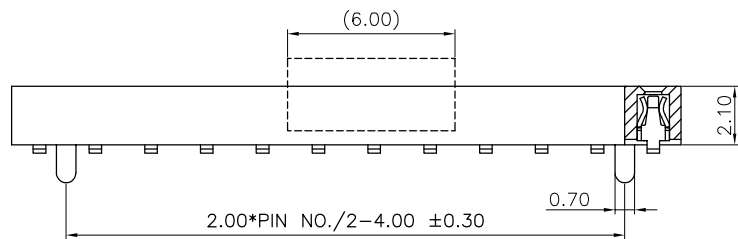
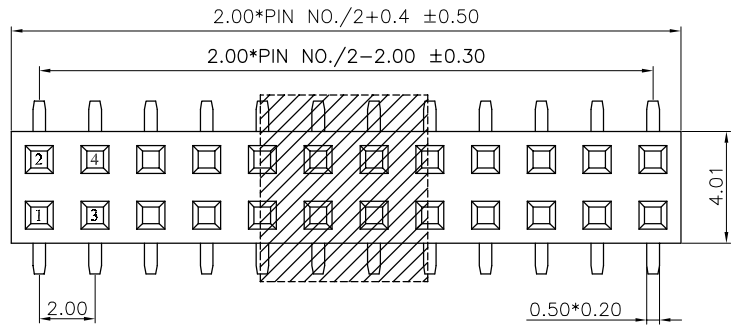

RECOMMENDED P.C.B LAYOUT
P.C.B TOLERANCE: ±0.05

NOTE:

- 1.MATERIAL SPECIFICATION:
1-1.HOUSING: LCP,UL94V-0
1-2.CONTACTS: BRASS
- 2.PLATING SPECIFICATION:
2-1.CONTACTS:
GOLD FLASH PLATED OVER ALL.
- 3.ELECTRICAL PERFORMANCE:
3-1.CURRENT RATING: 2A AC/DC
3-2.CONTACT RESISTANCE: 30 mΩ MAX
3-3.INSULATION RESISTANCE: 1000MΩ Min
3-4.DIELECTRIC WITHSTANDING : 300V
- 4.ENVIRONMENTAL PERFORMANCE:
4-1.OPERATING TEMPERATURE: -40°C~+105°C.
- 5.PACKAGE SPEC: REEL
- 6.P/N:

FH2005 21 F 0-2 XX 2 X X X 01

SERIES NO: _____ HOUSING: 1-LCP

HEIGHT: _____ 21: 2.1mm

MALE FEMALE: _____ COLOR: A-BLACK

ANGLE: _____ 0-180°

ROW NO: _____ 2-DOUBLE ROW

PIN Q'PY: _____ TERMPOINT: 2-SMT

REV.	REVISION RECORD	DATE		GENERAL TOLERANCES		SCALE: 1:1	NAME	DATE	PART.NO:	DWG.NO:	 WanLian Technology Co., Ltd
AO	NEW RELEASE	22.10.28		LINEAR	ANGLES	APPROVED	Wang_jr	22.10.28	FH200521F0-2XX2XXX01	ENDE05	
			UNIT:mm	0.00±0.25	X'±3°	DESIGNER	Han_Gao	22.10.28	TITLE:		REV: A0 SHEET: 1/1
			SIZE: A4	0.000±0.10	X'X' ±2°	DRAWN	LanXuan_Hou	22.10.28	Pitch 2.00mm 双排排母 SMT		