

The product using material and processing must conform to the "WL-PZ-001" HSF technical standard control requirements

RoHS

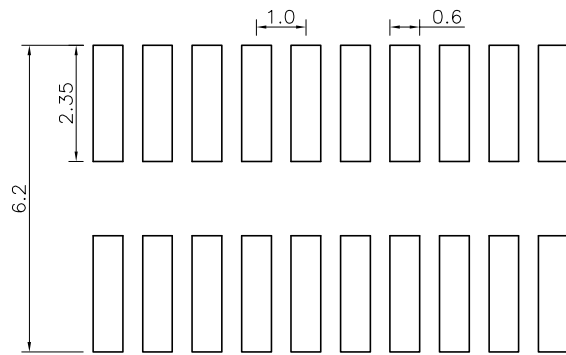
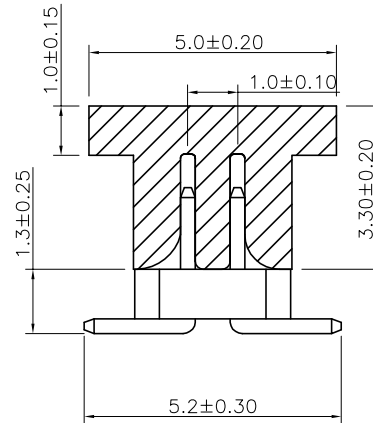
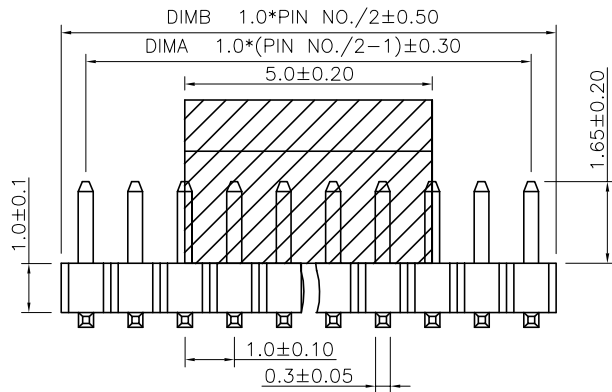
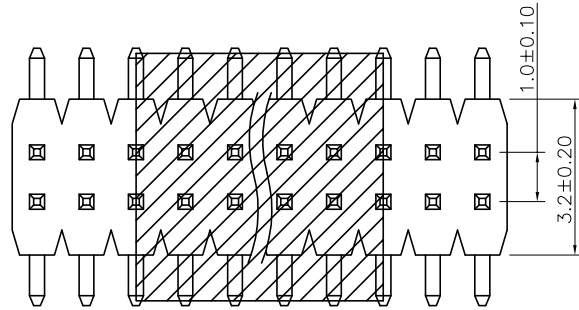

Recommended PCB layout

NOTE:
 1.MATERIAL SPECIFICATION:
 1-1.HOUSING: UL94V-0
 1-2.CONTACTS: PHOSPHOR BRONZE
 2.PLATING SPECIFICATION:
 2-1.CONTACTS:
 TIN/GOLD FLASH PLATED OVER ALL.
 3.MECHANICAL PERFORMANCE:
 3-1.RETENTIVITY FORCE: 0.2KGF/pin min
 3-2.DURABILITY: 100 CYCLES.
 4.ELECTRICAL PERFORMANCE:
 4-1.CURRENT RATING: 1A AC/DC
 RATED VOLTAGE : 300V AC/DC
 4-2.CONTACT RESISTANCE: 20 mΩ MAX
 4-3.INSULATION RESISTANCE: 1000MΩ Min
 4-4.DIELECTRIC WITHSTANDING : 300V
 5.ENVIRONMENTAL PERFORMANCE:
 5-1.OPERATING TEMPERATURE: -40°C~+105°C.
 6.PACKAGE SPEC: REEL
 7.P/N:
 PH1007 10 M 0-2 XX 2 X X X 02
 SERIES NO: PH1007 10 M 0-2 XX 2 X X X 02
 HEIGHT: 10: 1.0mm
 MALE FEMALE: M-MALE
 ANGLE: 0-180°
 ROW NO: 2-DOUBLE ROW
 PIN Q'PY: 04~100
 HOUSING: 1-PA9T
 COLOR: A-BLACK
 PLATING: A-ALL AU G/F
 TERMIPOINT: 2-SMT

PIN NO.	DIMENSION DIMA	DIMB	PIN NO.	DIMENSION DIMA	DIMB	PIN NO.	DIMENSION DIMA	DIMB	PIN NO.	DIMENSION DIMA	DIMB
2*2	1.0	2.0	2*14	13.0	14.0	2*27	26.0	27.0	2*40	39.0	40.0
2*3	2.0	3.0	2*15	14.0	15.0	2*28	27.0	28.0	2*41	40.0	41.0
2*4	3.0	4.0	2*16	15.0	16.0	2*29	28.0	29.0	2*42	41.0	42.0
2*5	4.0	5.0	2*17	16.0	17.0	2*30	29.0	30.0	2*43	42.0	43.0
2*6	5.0	6.0	2*18	17.0	18.0	2*31	30.0	31.0	2*44	43.0	44.0
2*7	6.0	7.0	2*19	18.0	19.0	2*32	31.0	32.0	2*45	44.0	45.0
2*8	7.0	8.0	2*20	19.0	20.0	2*33	32.0	33.0	2*46	45.0	46.0
2*9	8.0	9.0	2*21	20.0	21.0	2*34	33.0	34.0	2*47	46.0	47.0
2*10	9.0	10.0	2*22	21.0	22.0	2*35	34.0	35.0	2*48	47.0	48.0
2*11	10.0	11.0	2*23	22.0	23.0	2*36	35.0	36.0	2*49	48.0	49.0
2*12	11.0	12.0	2*24	23.0	24.0	2*37	36.0	37.0	2*50	49.0	50.0
2*13	12.0	13.0	2*25	24.0	25.0	2*38	37.0	38.0			
			2*26	25.0	26.0	2*39	38.0	39.0			

REV.	REVISION RECORD	DATE	UNIT:mm	GENERAL TOLERANCES		SCALE:	NAME	DATE	PART.NO:	DWG.NO:	REV: A0	SHEET: 1/2
AO	NEW RELEASE	22.05.09		LINEAR	ANGLES	1:1	Wang_jr	22.05.09				
			0.0±0.35	X'REF±6°		Han_Gao	22.05.09					
			0.00±0.25	X'±3°		LanXuan_Hou	22.05.09					
			SIZE: A4	0.000±0.10	X'X' ±2°							



The product using material and processing must conform to the "WL-PZ-001" HSF technical standard requirements

RoHS

PIN	W	F
2*3-6	16	7.50
2*7-14	24	11.50
2*15-18	32	14.20
2*19-30	44	20.20
2*31-43	56	26.20
2*44-50	72	34.20

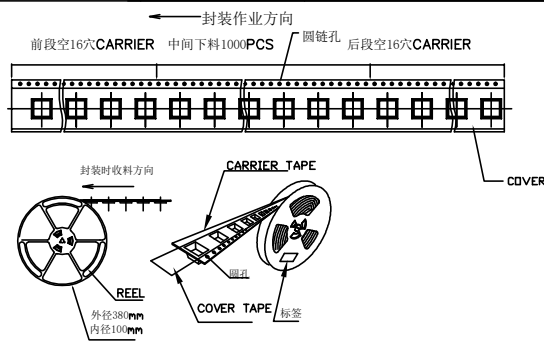

W	R(卷)/C(箱)	pcs/R(卷)
W16	14	1000
W24	10	1000
W32	8	1000
W44	6	1000
W56	5	1000
W72	4	1000

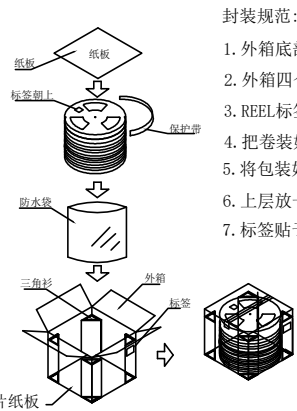

封装规范:

1. 外箱底部先垫一片纸板
2. 外箱四个内角各放置一个角彩
3. REEL 标签一律朝上
4. 把卷装好的产品平放防水袋
5. 将包装好的产品放进外箱
6. 上层放一片纸板
7. 标签贴于箱外

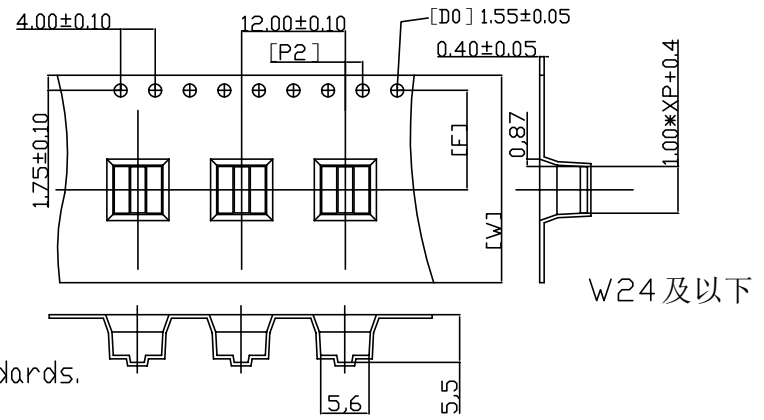

W24 及以下

- Notes:
1. Packing Conforms EIA-481-C Standards.
 2. 10 sprocket hole pitch cumulative±0.20MM
 3. Carrier camber is within 1mm in 250mm.
 4. Material: BLACK Polystyrene.
 5. Packing length per 13" Reel: 13 Meters.
 6. Component load per 13" Reel: 1000+32 PCS.

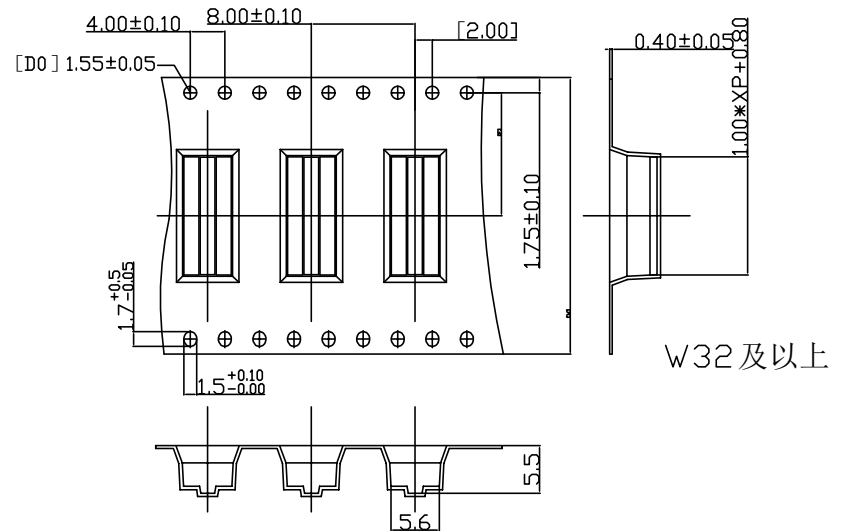

W32 及以上

REV.	REVISION RECORD	DATE	GENERAL TOLERANCES		SCALE:	NAME	DATE	PART.NO:	DWG.NO:	 WanLian Technology Co., Ltd	
AO	NEW RELEASE	22.05.09	LINEAR	ANGLES	1:1	APPROVED	Wang_jr	22.05.09	ENDE05		
			0.0±0.35	X°REF±6'		DESIGNER	Han_Gao	22.05.09	TITLE:		
			0.00±0.25	X'±3'		DRAWN	LanXuan_Hou	22.05.09	PH1.0 双排排针 包装图		
			UNIT:mm	X'±3'						REV: A0	SHEET: 2/2
			SIZE: A4	X°X'±2'							