

The product using material and processing must conform to the "WI-PZ-001"HSF technical standard control requirements

RoHS

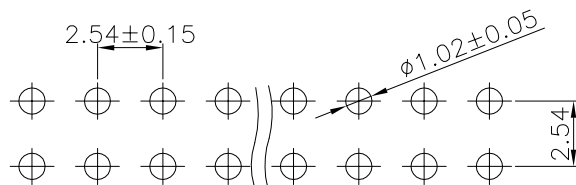
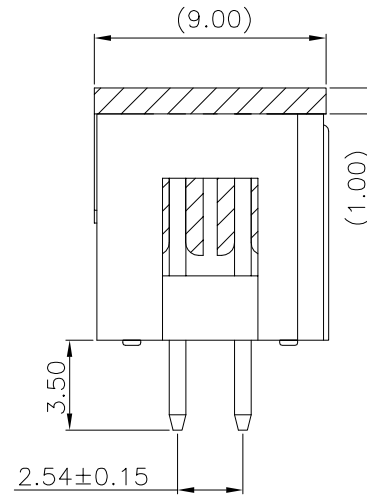
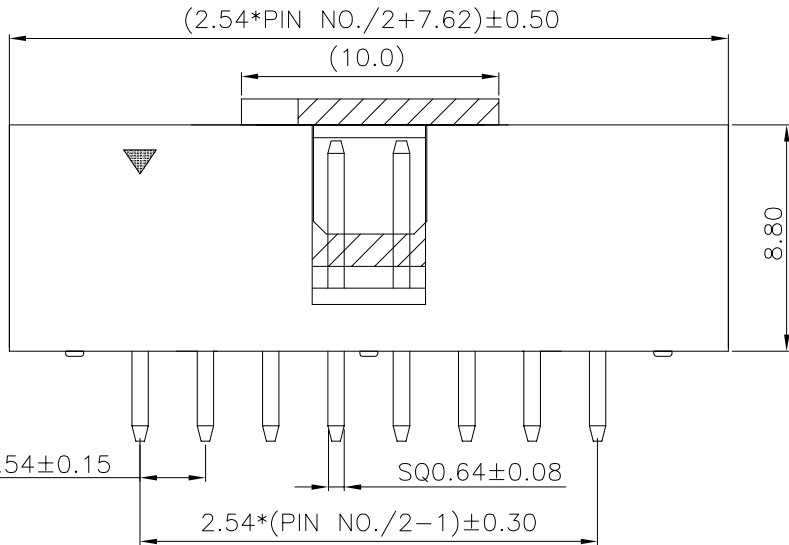
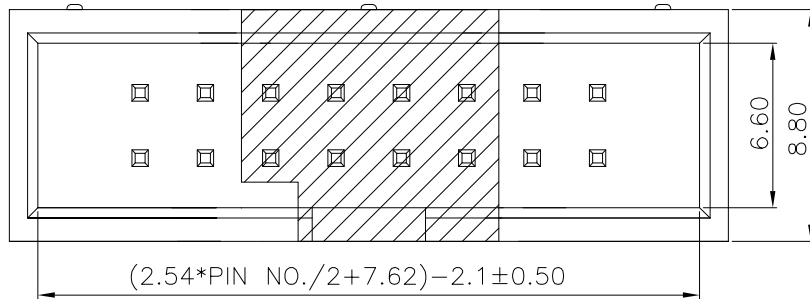

PCB Layout

NOTE:

- 1.MATERIAL SPECIFICATION:
 - 1-1.HOUSING: PA9T,UL94V-0
 - 1-2.CONTACTS: BRASS
- 2.PLATING SPECIFICATION:
 - 2-1.CONTACTS: GOLD FLASH/TIN OVER NICKEL
- 3.ELECTRICAL PERFORMANCE:
 - 3-1.CURRENT RATING: 3A
 - 3-2.CONTACT RESISTANCE: 30 mΩ MAX
 - 3-3.INSULATION RESISTANCE: 1000MΩ Min
 - 3-4.DIELECTRIC WITHSTANDING : 500V
- 4.ENVIRONMENTAL PERFORMANCE:
 - 4-1.OPERATING TEMPERATURE: -40°C~+105°C.
- 5.PACKAGE SPEC: REEL
- 6.P/N:

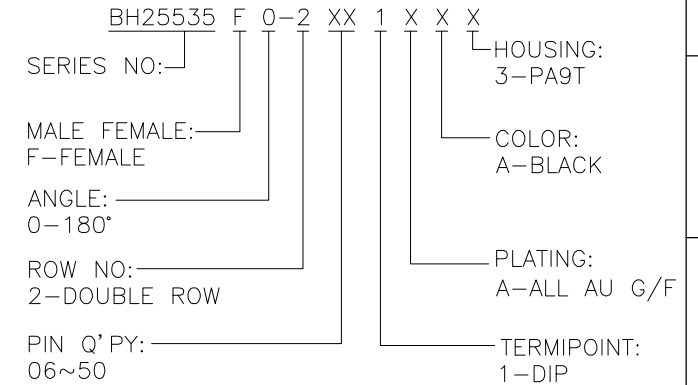

REV.	REVISION RECORD	DATE		GENERAL TOLERANCES		SCALE: 1:1	NAME	DATE	PART.NO:	DWG.NO:	 WanLian Technology Co., Ltd
A0	NEW RELEASE	21.10.15		LINEAR	ANGLES	APPROVED	Wang_jr	21.10.15	BH25535F0-2XX1XXX	ENDE05	
			UNIT:mm	0.00±0.25	X'±3'	DESIGNER	Gao_Han	21.10.15	TITLE: Pitch 2.54mm 180° 双排 DIP+CAP 筒牛 PC:3.3MM		REV: A0 SHEET: 1/2
			SIZE: A4	0.000±0.10	X'X' ±2'	DRAWN	Gao_Han	21.10.15			

The product using material and processing must conform to the "WI-PZ-001"HSF technical standard control requirements

RoHS

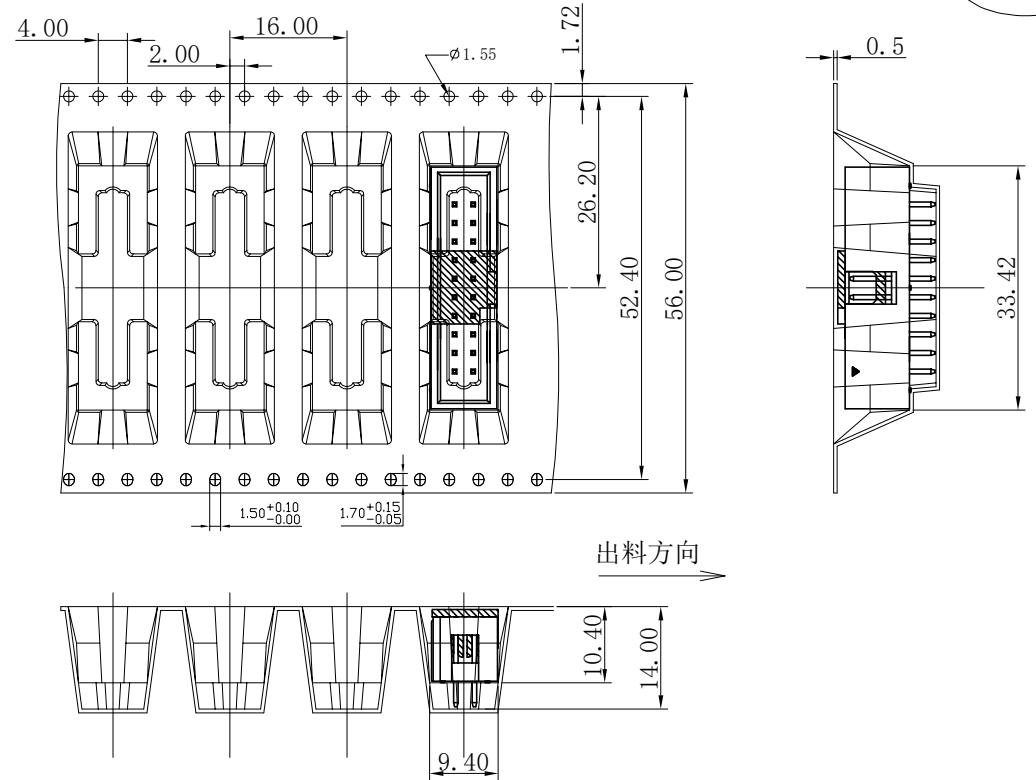
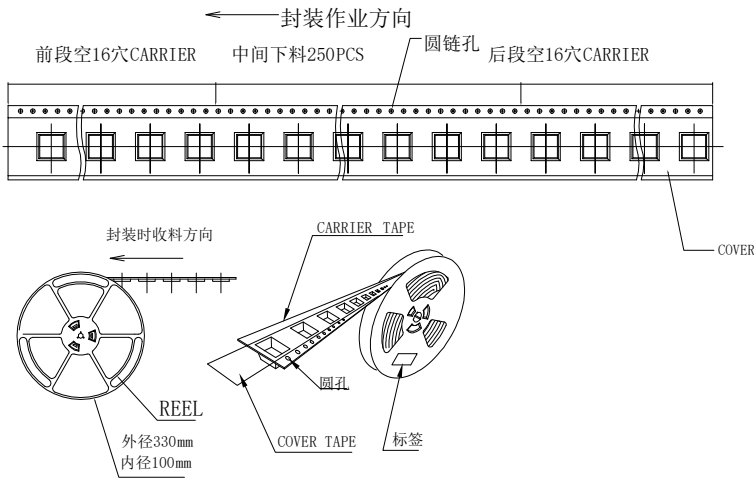

W	R(卷)/C(箱)	pcs/R(卷)
W56	5	250

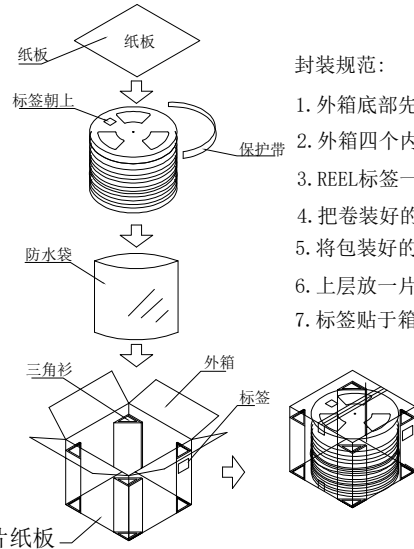

封装规范:

1. 外箱底部先垫一片纸板
2. 外箱四个内角各放置一个角衫
3. REEL标签一律朝上
4. 把卷装好的产品平放防水袋
5. 将包装好的产品放进外箱
6. 上层放一片纸板
7. 标签贴于箱外

Notes:

1. Packing Conforms EIA-481-C Standards.
2. 10 sprocket hole pitch cumulative $\pm 0.20\text{MM}$
3. Carrier camber is within 1mm in 250mm.
4. Material: BLACK Polystyrene.
5. Packing length per 13" Reel: 5Meters.
6. Component load per 13" Reel: 250+32PCS.

REV.	REVISION RECORD	DATE	GENERAL TOLERANCES		SCALE:	NAME	DATE	PART.NO:	DWG.NO:
AO	NEW RELEASE	21.10.15	 UNIT:mm SIZE: A4	LINEAR	1:1	Wang_jr	21.10.15	BH25535F0-2XX1XXX	ENDE05
				0.0 \pm 0.35	ANGLES	APPROVED	Gao_Han		
			0.00 \pm 0.25	X'REF \pm 6°	DESIGNER	Gao_Han	21.10.15	TITLE: Pitch 2.54mm 180° 双排 DIP+CAP 筒牛 包装图	
			0.000 \pm 0.10	X'X' \pm 2°	DRAWN	Gao_Han	21.10.15		

万连科技
WanLian Technology Co., Ltd

REV: A0 SHEET: 2/2