

The product using material and processing must conform to the "WI-PZ-001"HSF technical standard control requirements

RoHS+HF

NOTE:

1.MATERIAL SPECIFICATION:

- 1-1.HOUSING: HTN/LCP,UL94V-0
- 1-2.CONTACTS: BRASS
- 1-3.SOLDER TABS: BRASS

2.PLATING SPECIFICATION:

- 2-1.CONTACTS:
TIN/GOLD FLASH PLATED OVER ALL.
- 2-2.SOLDER TABS:
TIN/GOLD FLASH PLATED OVER ALL.

3.ELECTRICAL PERFORMANCE:

- 3-1.CURRENT RATING: 1A
RATED VOLTAGE : 125V
- 3-2.CONTACT RESISTANCE: 20 mΩ MAX
- 3-3.INSULATION RESISTANCE: 100MΩ Min
- 3-4.DIELECTRIC WITHSTANDING : 500V AC

4.ENVIRONMENTAL PERFORMANCE:

- 4-1.OPERATING TEMPERATURE: -25°C~+85°C.

5.PACKAGE SPEC: REEL

6.P/N:

A1009 W 9 1-1 XX 2 X X X

SERIES NO:

CONNECTOR:

ANGLE:

TYPE:

ROW NO:

PIN Q'PY:

COLOR:
0-HTN ROHS+HF
1-LCP ROHS+HF

COLOR:
A-BLACK
S-NATURE

PLATING:
A-ALL AU G/F
C-BRIGHT TIN
D-MATTE TIN

TERMIPOINT:
2-SMT

Circuit	Dimension(mm)			Circuit	Dimension(mm)		
	A	B	C		A	B	C
2	---	3.60	2.40	9	8.00	10.60	9.40
3	2.00	4.60	3.40	10	9.00	11.60	10.40
4	3.00	5.60	4.40	11	10.00	12.60	11.40
5	4.00	6.60	5.40	12	11.00	13.60	12.40
6	5.00	7.60	6.40	13	12.00	14.60	13.40
7	6.00	8.60	7.40	14	13.00	15.60	14.40
8	7.00	9.60	8.40	15	14.00	16.60	15.40

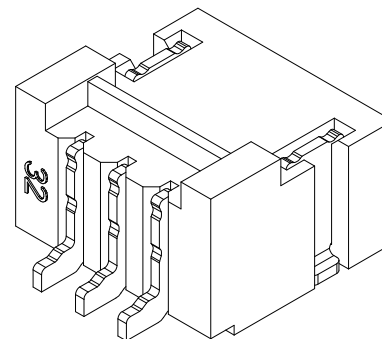
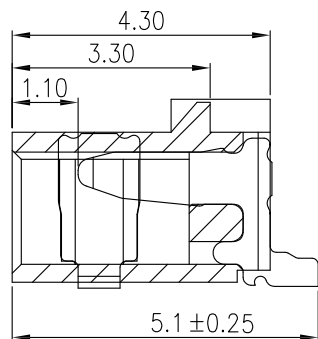
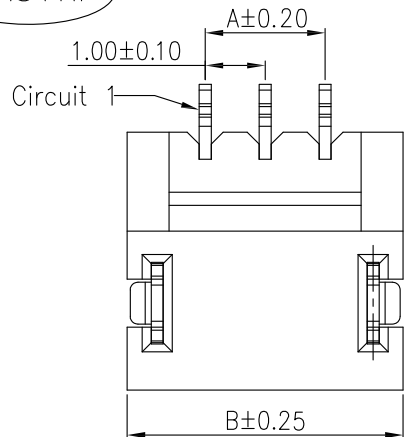

SECTION:A-A

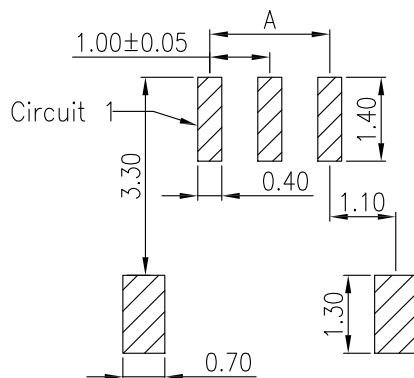
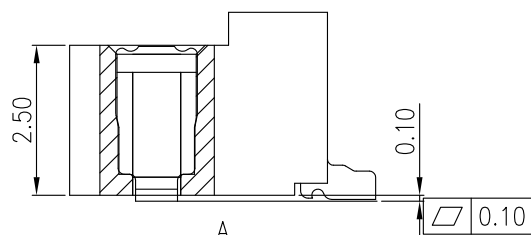
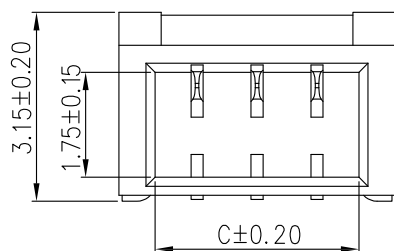

P.C.B Layout

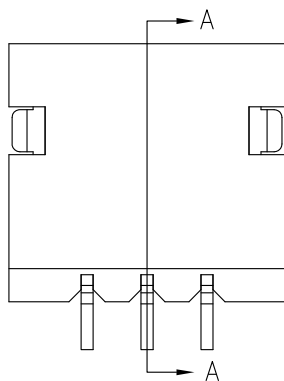

REV.	REVISION RECORD	DATE	GENERAL TOLERANCES		SCALE:	NAME	DATE	PART.NO:	DWG.NO:	 WanLian Technology Co., Ltd REV: A0 SHEET: 1/2
A0	NEW RELEASE	22.08.23	LINEAR	ANGLES	1:1	Wang_jr	22.08.23	A1009W91-1XX2XX0	ENDE05	
			0.0±0.35	X'REF±6°	APPROVED	XueZe_Ma	22.08.23	TITLE:		
			0.00±0.25	X'±3°	CHECK	LanXuan_Hou	22.08.23	Pitch1.0mm 90° NHB单排带扣卧贴 Wafer		
			UNIT:mm	X'X' ±2°	DRAWN					
			SIZE: A4	0.000±0.10						

The product using material and processing must conform to the "WI-PZ-001" HSF technical standard control requirements

RoHS+HF

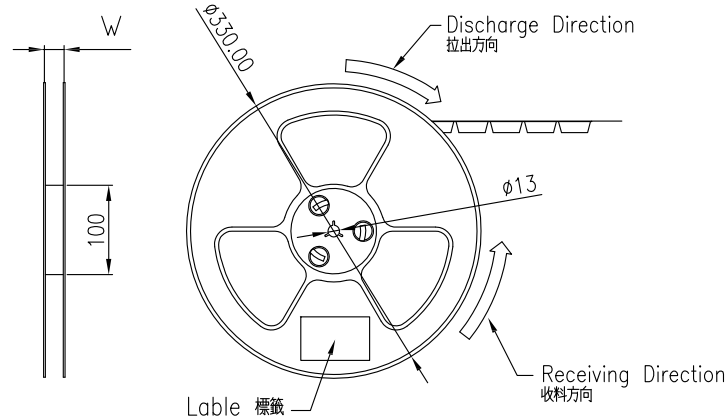
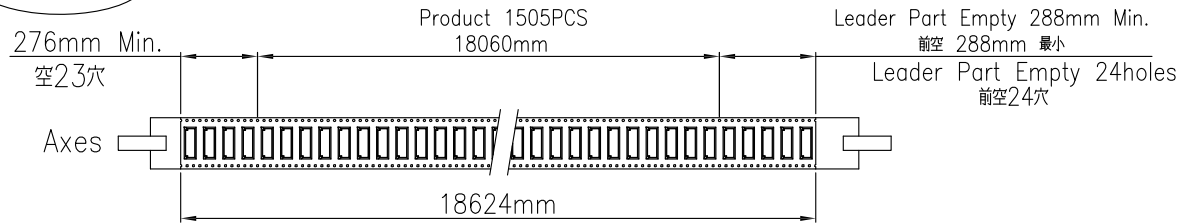

COVER TAPE PEEL STRENGTH: 20~120g
上带剥离力量: 20~120g

速度 PEEL SPEED: 300mm/minute

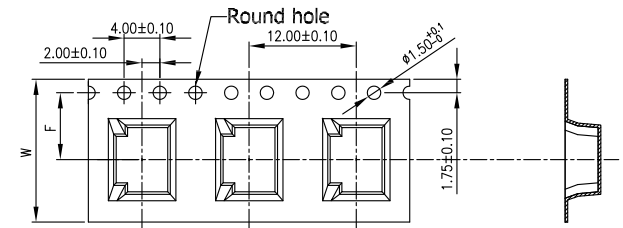
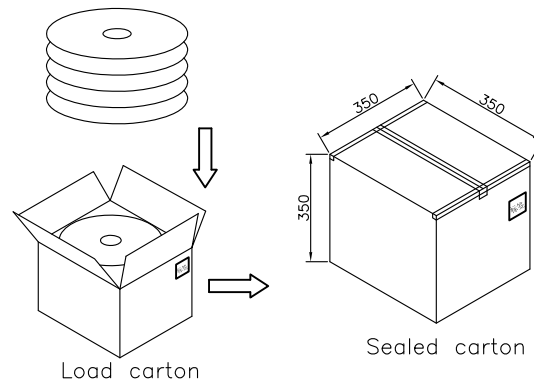
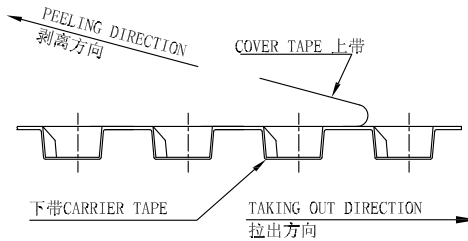

2~13 Contacts

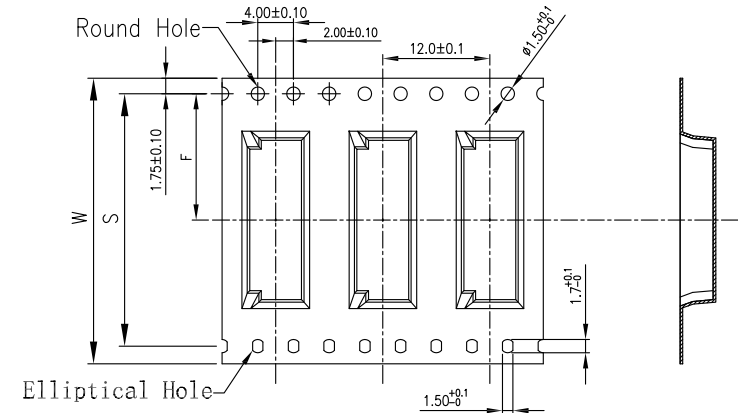

14~15 Contacts

Circuit	W ± 0.3	F ± 0.1	S ± 0.1	Q'ty/Reel	Q'ty/Box
02P	12	4.50	28.40	1,500	31,500
03P	16	7.50		1,500	24,000
04P	16	7.50		1,500	24,000
05P	16	7.50		1,500	24,000
06P	16	7.50		1,500	24,000
07P	16	7.50		1,500	24,000
08P	24	11.50		1,500	18,000
09P	24	11.50		1,500	18,000
10P	24	11.50		1,500	18,000
11P	24	11.50		1,500	18,000
12P	24	11.50		1,500	18,000
13P	24	11.50		1,500	18,000
14P	32	14.20		1,500	13,500
15P	32	14.20		1,500	13,500

REV.	REVISION RECORD	DATE	GENERAL TOLERANCES		SCALE:	NAME	DATE	PART.NO:	DWG.NO:
AO	NEW RELEASE	22.08.23	LINEAR	ANGLES	1:1	Wang_jr	22.08.23	A1009W91-1XX2XX0	ENDE05
			0.0 ± 0.35	X'REF $\pm 6^\circ$	APPROVED	XueZe_Ma	22.08.23	TITLE:	 WanLian Technology Co., Ltd REV: A0 SHEET: 2/2
			0.00 ± 0.25	X' $\pm 3^\circ$	CHECK	LanXuan_Hou	22.08.23	Pitch 1.0mm 90° NHB单排带扣卧贴 Wafer 包装规范	
			0.000 ± 0.10	X'X' $\pm 2^\circ$	DRAWN				