

The product using material and processing must conform to the "WI-PZ-001"HSF technical standard control requirements

RoHS

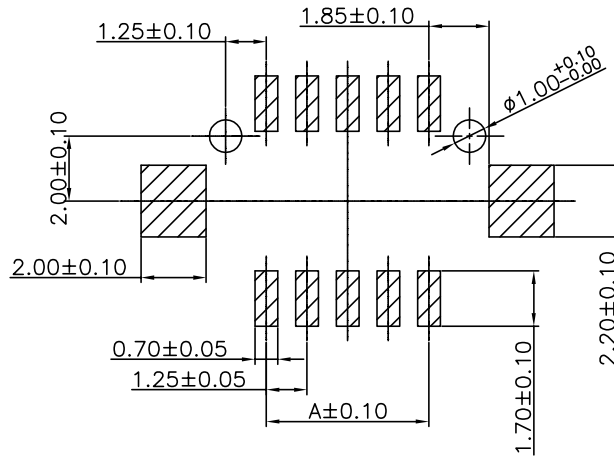

P.C.B LAYOUT

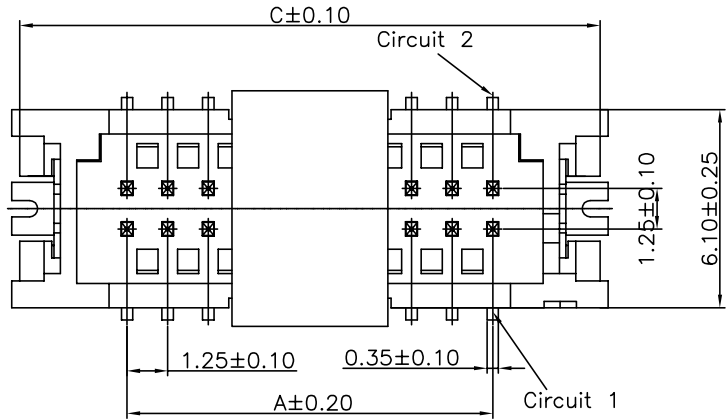
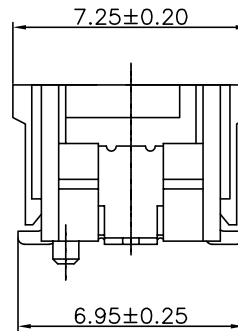
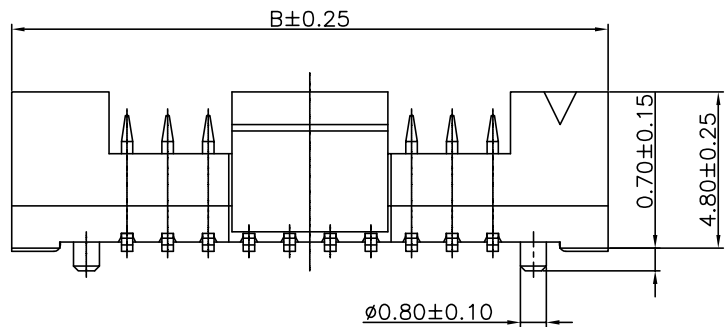

NOTE:

- 1.MATERIAL SPECIFICATION:
 - 1-1.HOUSING:PA6T,UL94V-0
 - 1-2.CAP:PA6T,UL94V-0
 - 1-2.CONTACTS:BRASS
- 2.PLATING SPECIFICATION:
 - 2-1.CONTACTS:
 - GOLD-FLASH(15u") ON CONTACT AREA
 - MATTE TIN PLATING ON SOLDER TAILS AREA.
- 4.ELECTRICAL PERFORMANCE:
 - 4-1. RATED CURRENT : 1A AC,DC
 - RATED VOLTAGE : 150V AC/DC
 - 4-2.INSULATION RESISTANCE: 500MΩ MIN
 - CONTACT RESISTANCE : 30mΩ(MAX.)
 - 4-3.WITHSTANDING VOLTAGE: 500V AC/minute
- 5.ENVIRONMENTAL PERFORMANCE:
 - OPERATING TEMPERATURE: -25°C~+85°C.
- 6.PACKAGE SPEC:REEL
- 7.P/N:

A1252 W 0 1-2 XX 2 X X 0
 SERIES NO: _____
 CONNECTOR: _____
 W-WAFER
 ANGLE: _____
 0-180°
 TYPE: _____
 1-TYPE 1
 ROW NO: _____
 2-DOUBLE ROW
 COLOR:
 A-BLACK
 S-NATURE
 PLATING:
 A-ALL AU G/F
 C-BRIGHE TIN
 5-AU 15U"
 TERMIPOINT:
 2-SMT
 PIN Q'PY:
 10~40

Ordering Information & Dimensions

Circuit	Dimensions(mm)		
	A	B	C
10	5.00	12.10	11.60
12	6.25	13.35	12.85
14	7.50	14.60	14.10
20	11.25	18.35	17.85
30	17.50	24.60	24.10
40	23.75	30.85	30.35

REV.	REVISION RECORD	DATE	GENERAL TOLERANCES		SCALE:	NAME	DATE	PART.NO:	DWG.NO:		
A0	NEW RELEASE	21.01.13	LINEAR	ANGLES	1:1	Wang_jr	23.10.10	A1252W01-2XX2XX0	ENDE05		
A1	PART NUMBER RENEWAL	23.10.10	0.00±0.25	X'REF±6'		Han_Gao	23.10.10	TITLE: 1.25mm PITCH 180°DUAL ROW WAFER			
			0.00±0.10	X'X' ±2'		Zijun_Huang	23.10.10				
			UNIT:mm								
			SIZE: A4							REV: A1	SHEET: 1/2

The product using material and processing must conform to the "WI-PZ-001"HSF technical standard control requirements

RoHS

2X05~2X07 Contacts

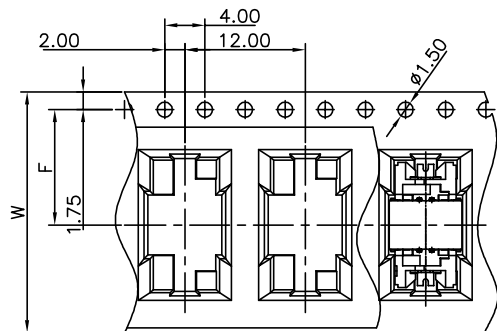

2X10~2X20 Contacts

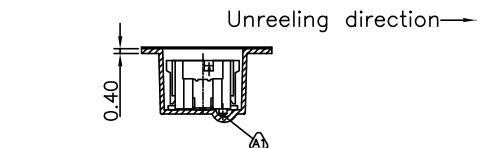
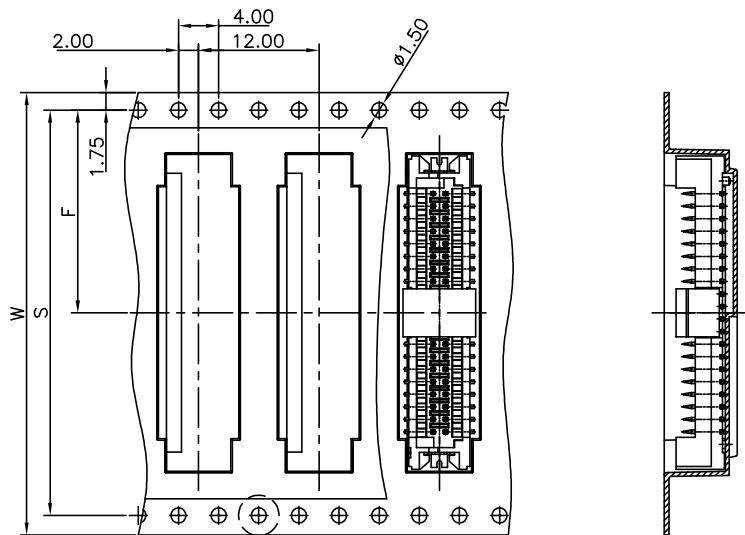

Carrier tape

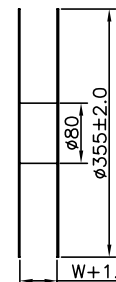
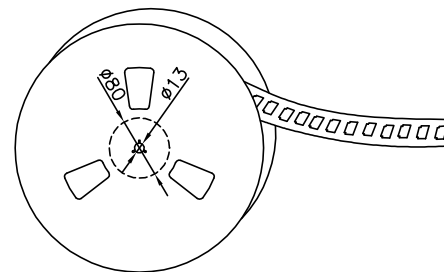
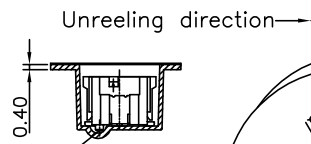
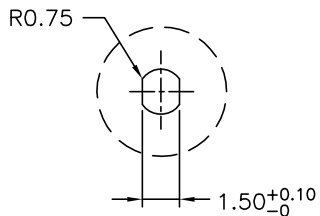
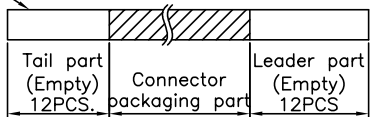

Number of Contacts	W±0.3	F±0.1	S±0.1	Q'ty/Reel
2X05P	24	11.50	/	1,000
2X06P	24	11.50		1,000
2X07P	24	11.50		1,000
2X10P	32	14.20	28.40	1,000
2X15P	44	20.20	40.40	1,000
2X20P	44	20.20	40.40	1,000

REV.	REVISION RECORD	DATE	GENERAL TOLERANCES		SCALE:	NAME	DATE	PART.NO:	DWG.NO:	 WanLian Technology Co., Ltd
A0	NEW RELEASE	21.01.13		LINEAR	1:1	Wang_jr	23.10.10	A1252W01-2XX2XX0	ENDE05	
A1	PART NUMBER RENEWAL	23.10.10		ANGLES	APPROVED					
			UNIT:mm	0.00±0.25	X'±3'	DESIGNER	Han_Gao	23.10.10	TITLE:	
			SIZE: A4	0.000±0.10	X'X' ±2'	DRAWN	Zijun_Huang	23.10.10	1.25mm PITCH 180°DUAL ROW WAFER	

REV: A1 SHEET: 2/2