

The product using material and processing must conform to the "WI-PZ-001"HSF technical standard control requirements

RoHS+HF

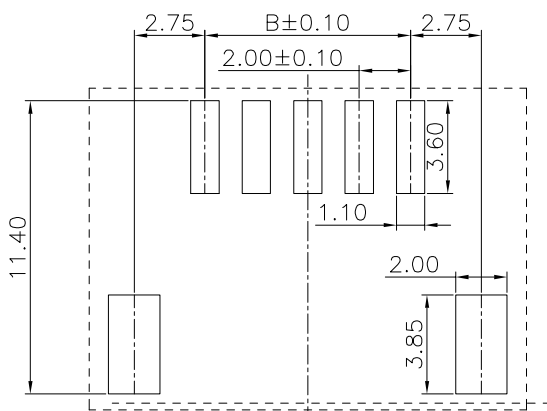
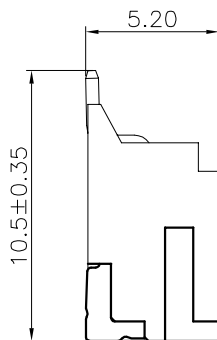
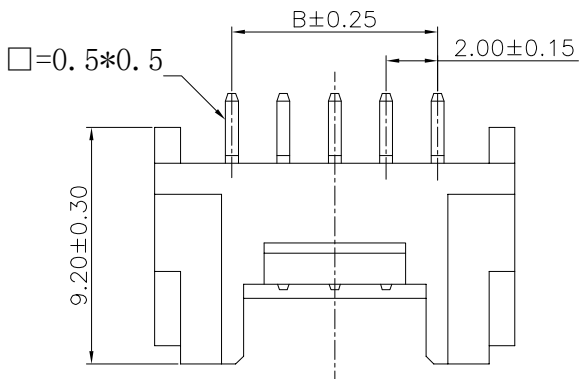
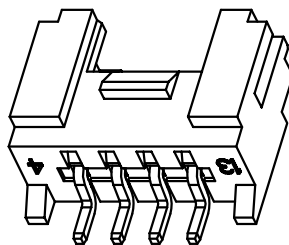
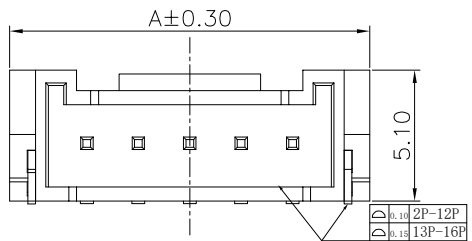

RECOMMENDED PCB LAYOUT  
(GENERAL TOLERANCE:±0.05)

NOTE:

- MATERIAL SPECIFICATION:
  - HOUSING: PA6T/LCP
  - CONTACTS: BRASS
  - SOLDERING LUG: BRASS
- PLATING SPECIFICATION:
  - CONTACTS:SN PLATED OVER ALL.
  - SOLDERING LUG:SN PLATED OVER ALL.
- ELECTRICAL PERFORMANCE:
  - CURRENT RATING: 2.0A
  - CONTACT RESISTANCE: 20mΩ Max.
  - INSULATION RESISTANCE: 1000MΩ MIN
  - DIELECTRIC WITHSTANDING:1000V AC Min
- ENVIRONMENTAL PERFORMANCE:
  - OPERATING TEMPERATURE: -25°C~+85°C.
- PACKAGE SPEC:REEL
- P/N ORDER:



SERIES NO: A2008 W 9-1 XX 2 X X X  
 CONNECTOR: W-WAFER  
 ANGLE: 9-90°  
 ROW NO: 1-SINGLE ROW  
 PIN Q'PY: 02~16

WATER CODE  
 1-PA6T,UL94V-0  
 2-LCP,UL94V-0  
 COLOR:  
 A-BLACK  
 S-NATURE  
 PLATING:  
 A-ALL AU G/F  
 C-BRIGHT TIN  
 D-MATTE TIN  
 TERMIPOINT:  
 2-SMT

Ordering Information & Dimensions

Circuits	Dimensions(mm)		Circuits	Dimensions(mm)	
	A	B		A	B
02	8.00	2.00	10	24.00	18.00
03	10.00	4.00	11	26.00	20.00
04	12.00	6.00	12	28.00	22.00
05	14.00	8.00	13	30.00	24.00
06	16.00	10.00	14	32.00	26.00
07	18.00	12.00	15	34.00	28.00
08	20.00	14.00	16	36.00	30.00
09	22.00	16.00			

REV.	REVISION RECORD	DATE		GENERAL TOLERANCES		SCALE: 1:1	NAME	DATE	PART.NO: A2008W9-1XX2XXX	DWG.NO: ENDE05	
A0	NEW RELEASE	21.01.13		LINEAR	ANGLES	APPROVED	Wang_jr	23.09.15			
A1	PART NUMBER RENEWAL	23.09.15	UNIT:mm	X'REF±6°	DESIGNER	Han_Gao	23.09.15	TITLE: PITCH 2.0MM 90°HY LIE ON WAFER			
			SIZE: A4	X'X' ±2°	DRAWN	Zijun_Huang	23.09.15		REV: A1	SHEET: 1/2	

The product using material and processing must conform to the "WI-PZ-001"HSF technical standard control requirements

RoHS+HF

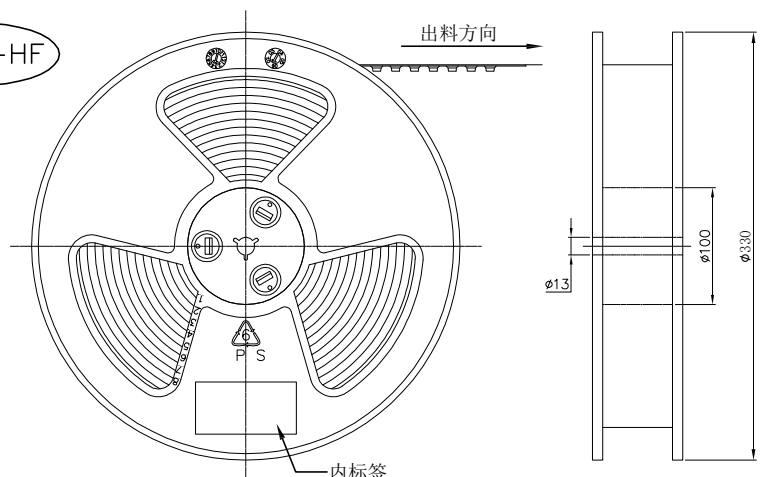

备注:

- 1、10个孔的累积公差为±0.2mm
- 2、载长250mm内允许弯曲度1.0mm
- 3、材质: PS;100%回收再利用
- 4、所以尺寸符合EIA-481-C要求
- 5、上封带剥离强度: 20g~130g(0.2N~1.3N)
- 6、13英寸的卷盘每卷可装载700PCS

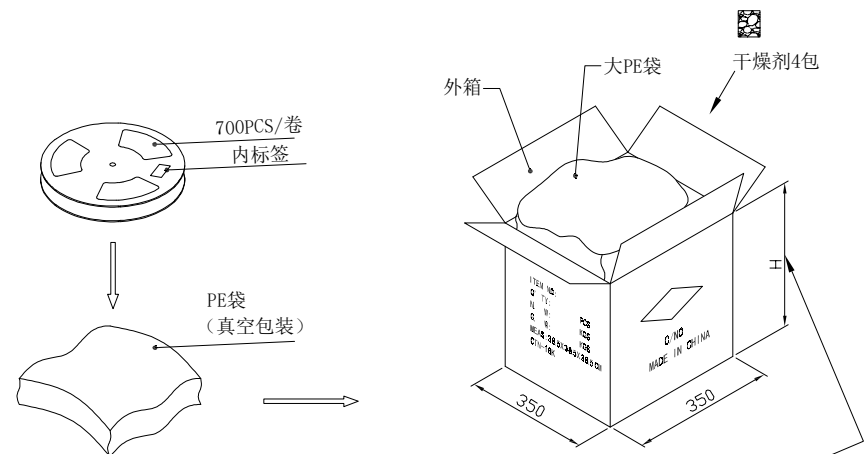
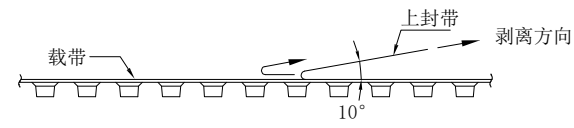
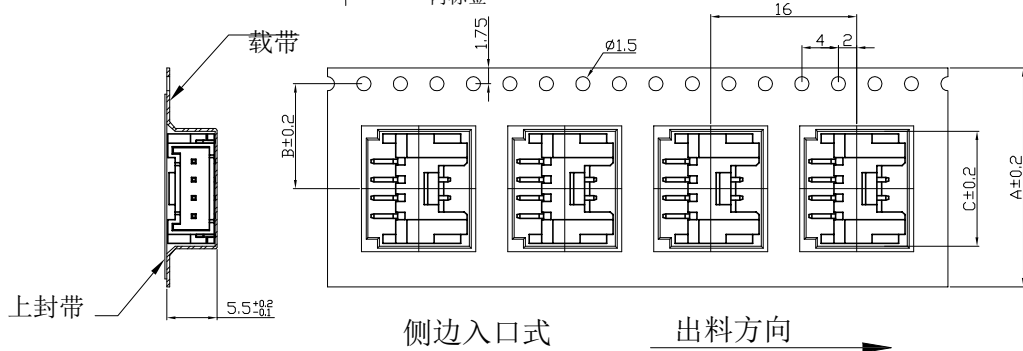
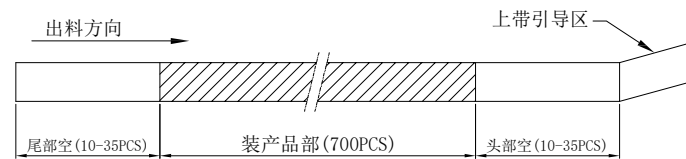

Circuits	DIM=A	DIM=B	DIM=C	1盘/只	1箱/盘	Circuits	DIM=A	DIM=B	DIM=C	1盘/只	1箱/盘
2P	16	7.5	8.2	700只	14盘	9P	44	20.2	22.3	700只	6盘
3P	24	11.5	10.2	700只	10盘	10P	44	20.2	24.3	700只	6盘
4P	24	11.5	12.2	700只	10盘	11P	44	20.2	26.3	700只	6盘
5P	24	11.5	14.2	700只	10盘	12P	44	20.2	28.3	700只	6盘
6P	24	11.5	16.2	700只	10盘	13P	44	20.2	30.3	700只	6盘
7P	32	14.2	18.3	700只	8盘	14P	44	20.2	32.3	700只	6盘
8P	32	14.2	20.3	700只	8盘	15P	56	26.2	34.3	700只	5盘
						16P	56	26.2	36.3	700只	5盘

纸箱型号	小型	中型	标准型
Carton Type	Small Size	Medium	Standard
高度	7.5	15	32
Hight (CM)			

REV.	REVISION RECORD	DATE	GENERAL TOLERANCES	SCALE:	NAME	DATE	PART.NO:	DWG.NO:
A0	NEW RELEASE	21.01.13	LINEAR	1:1	Wang_jr	23.09.15	A2008W9-1XX2XXX	ENDE05
A1	PART NUMBER RENEWAL	23.09.15	ANGLES		Han_Gao	23.09.15		
			0.00±0.25		Zijun_Huang	23.09.15	TITLE:	
			0.000±0.10				PACKAGE DRAWING	



REV: A1 SHEET: 2/2