

The product using material and processing must conform to the "WI-PZ-001"HSF technical standard control requirements

RoHS

NOTE:

1.MATERIAL SPECIFICATION:

1-1.HOUSING: PA46,UL94V-0

1-2.CONTACTS: BRASS

2.PLATING SPECIFICATION:

2-1.CONTACTS:

TIN/GOLD FLASH PLATED OVER ALL.

3.MECHANICAL PERFORMANCE:

3-1.RETENTIVITY FORCE: 1.0kgf/PIN MIN

3-2.DURABILITY: 50 CYCLES.

4.ELECTRICAL PERFORMANCE:

4-1.CURRENT RATING: 3A

RATED VOLTAGE : 250V AC/DC

4-2.CONTACT RESISTANCE: 30 mΩ MAX

4-3.INSULATION RESISTANCE: 1000MΩ Min

4-4.DIELECTRIC WITHSTANDING : 1000V

5.ENVIRONMENTAL PERFORMANCE:

5-1.OPERATING TEMPERATURE: -25°C~+85°C.

6.PACKAGE SPEC:REEL

7.P/N:



A2009 W 9-2 XX 2 X X 0

SERIES NO:

CONNECTOR:

W-WAFER

ANGLE:

9-90°

ROW NO:

2-DOUBLE ROW

PIN Q'PY:

04~30

COLOR:

A-BLACK

S-NATURE

PLATING:

A-ALL AU G/F

C-BRIGHT TIN

D-MATTE TIN

TERMIPOINT:

2-SMT

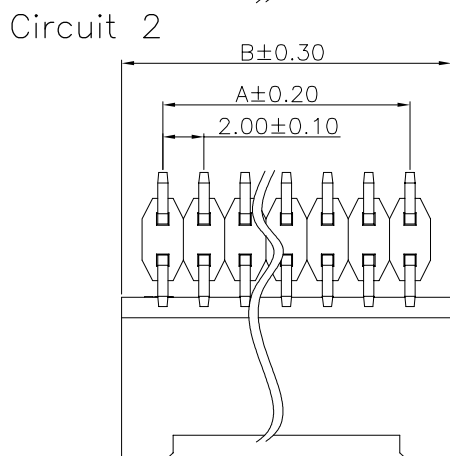
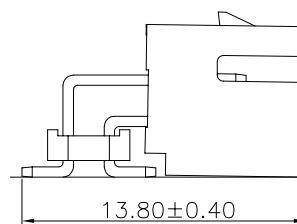
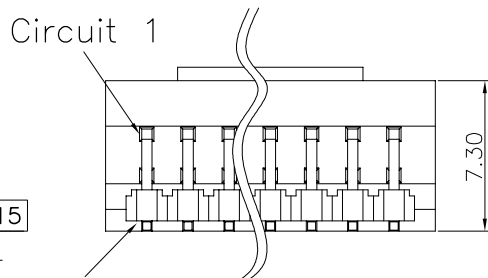
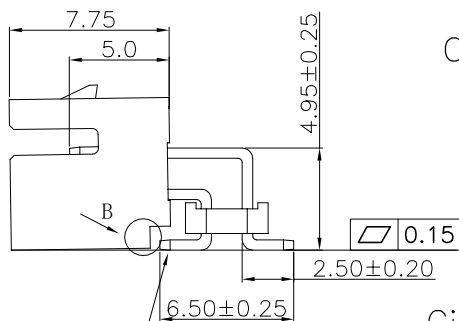

1.The flatness of the pin header is controlled within +0.15mm max;
2. When placed in a natural state, the pin header is OK, the head of the rubber shell needs to be attached to the board, and the maximum gap between the root and the plane is 0.6mm max.

Circuit	Dimensions(mm)		Circuit	Dimensions(mm)	
	A	B		A	B
2*02	2.00	6.00	2*09	16.00	20.00
2*03	4.00	8.00	2*10	18.00	22.00
2*04	6.00	10.00	2*11	20.00	24.00
2*05	8.00	12.00	2*12	22.00	26.00
2*06	10.00	14.00	2*13	24.00	28.00
2*07	12.00	16.00	2*14	26.00	30.00
2*08	14.00	18.00	2*15	28.00	32.00

REV.	REVISION RECORD	DATE	GENERAL TOLERANCES		SCALE:	NAME	DATE	PART.NO:	DWG.NO:	 WanLian Technology Co., Ltd
AO	NEW RELEASE	21.10.12	 UNIT: mm SIZE: A4	LINEAR	1:1	APPROVED	23.09.21	A2009W9-2XX2XX0	ENDE05	
A1	PART NUMBER RENEWAL	23.09.21		ANGLES		DESIGNER	23.09.21			
			0.00±0.25	X'±3'	DRAWN	23.09.21	TITLE:		REV: A1	
			0.000±0.10	X'X' ±2'			Pitch 2.0mm 90°PHB双排带扣卧贴 无logo Wafer			

The product using material and processing must conform to the "WI-PZ-001"HSF technical standard control requirements

备注:

- 任意连续10个链条孔的累计误差不超过±0.2mm;
- 材料厚度以在载带边缘测量为准;
- 载带长度方向250mm距离的非平行度不可超过1mm;
- 未注明公差范围为: +/-0.1mm;
- A0、B0非标注依型腔内侧最底部最小处测量为准;
- K0非标注依型腔内底部到皮料表面处测量为准;
- 型腔内形凡未标明处倒角为R0.5以下;
- 全尺寸符合《EIA-481-D》规范要求;
- 13"圆盘包装零件个数为:300+40PCS 6.50M;
- 材质:透明 PS.
- 前后各空20PCS

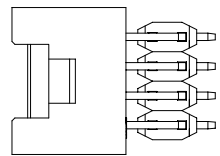

产品示意图

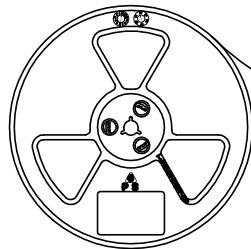

放大示意图

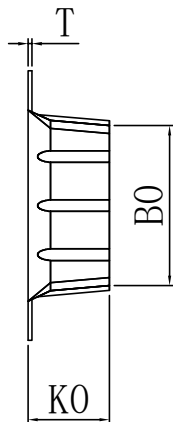
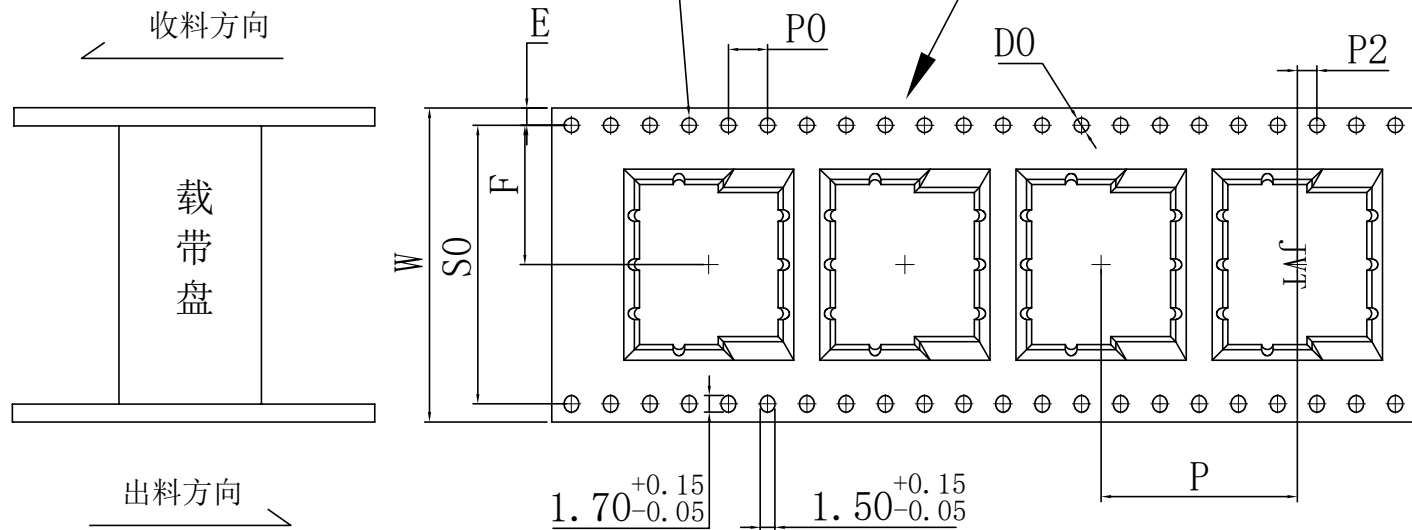

类别	宽度(mm)			
下载带	16	24	32	44
上载带	12.8	20.7	25.5	37.5

ITEM	W	A0	B0	K0	S0	E	F	DO	D1	P	P0	P2	T
DIM	32.00	14.15	16.30	8.30	28.40	1.75	14.20	1.50	/	20.00	4.00	2.00	0.40
TOLE	+0.30 -0.30	+0.10 -0.10	+0.10 -0.10	+0.10 -0.10	+0.10 -0.10	+0.10 -0.10	+0.10 -0.10	+0.15 -0.00	+0.10 -0.10	+0.10 -0.10	+0.10 -0.10	+0.10 -0.10	+0.05 -0.05

REV.	REVISION RECORD	DATE	GENERAL TOLERANCES		SCALE:	NAME	DATE	PART.NO:	DWG.NO:	 WanLian Technology Co., Ltd
A0	NEW RELEASE	21.10.12	 LINEAR	 ANGLES	1:1	Wang_jr	23.09.21	A2009W9-2XX2XX0	ENDE05	
A1	PART NUMBER RENEWAL	23.09.21			0.0±0.35					
			UNIT: mm	0.00±0.25	X'±3°	DESIGNER	Han_Gao	23.09.21	TITLE:	
			SIZE: A4	0.000±0.10	X'X' ±2'	DRAWN	Zijun_Huang	23.09.21	包装规范	

REV: A1 SHEET: 2/2