

The product using material and processing must conform to the "WI-PZ-001"HSF technical standard control requirements

RoHS

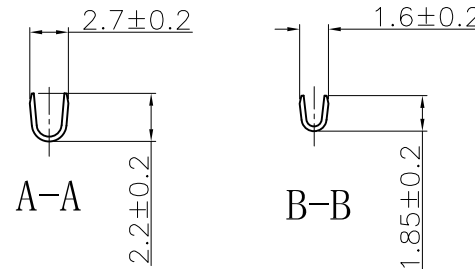
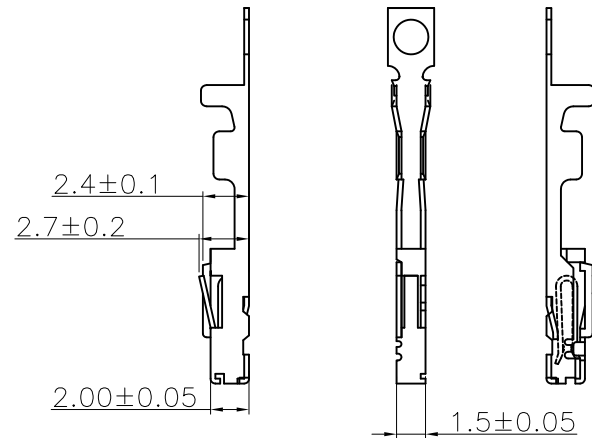
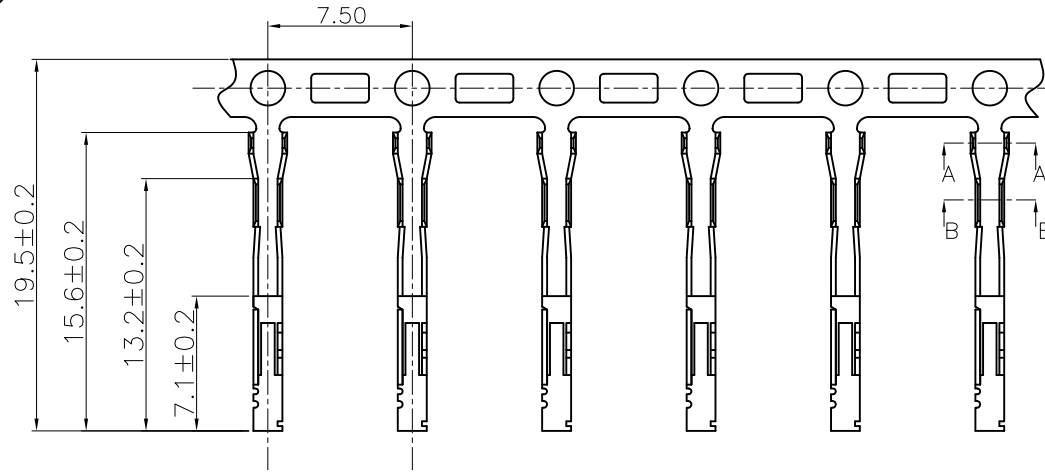

NOTE:

- 1.MATERIAL SPECIFICATION:
 - 1-1.TERMINAL:PHOSPHOR BRONZE
 - 1-2.APPLICABLE WIRE:AWG#20~#26
 - 2.PLATING SPECIFICATION:
 - 2-1.TREMINAL: TIN-PLATED ON CONTACT AREA.
 - 3.MECHANICAL PERFORMANCE:
 - 3-1.INSERTION FORCE: 1KGF/PIN MAX
 - 3-2.REMOVAL FORCE: 3KGF/PIN MIN
 - 3-3.DURABILITY: 25 CYCLES.
 - 4.ELECTRICAL PERFORMANCE:
 - 4-1. RATED CURRENT : 10A
 - 4-2.INSULATION RESISTANCE: 1000MΩ MIN
 - 4-3.CONTACT RESISTANCE : 30mΩ MAX
 - 4-4.WITHSTANDING VOLTAGE: 1500V AC
 - 5.ENVIRONMENTAL PERFORMANCE:
 - OPERATING TEMPERATURE: -40°C~+90°C.
 - 5.PACKAGE SPEC:PAPER PLATE
 - 6.P/N: A2201 T F X-X
- SERIES NO: _____ PLATING:
 A-ALL AU G/F
 C-BRIGHE TIN
 D-MATTE TIN
- CONNECTOR: _____ METAL:
 T-TERMINAL P-PHOSPHOR BRONZE
 B-BRASS
- MALE FEMALE: _____
 F-FEMALE

REV.	REVISION RECORD	DATE		GENERAL TOLERANCES		SCALE: 1:1	NAME	DATE	PART.NO:	DWG.NO:	
A0	NEW RELEASE	21.01.13		LINEAR	ANGLES	APPROVED	Wang_jr	21.01.13	A2201TFX-X	ENDE05	
			UNIT:mm	0.00±0.25	X°±3°	DESIGNER	Han_Gao	21.01.13	TITLE:		REV: A0 SHEET: 1/1
			SIZE: A4	0.000±0.10	X°X' ±2°	DRAWN	Zijun_Huang	21.01.13	PITCH 2.20mm母端子 AWG20#~26#		