

The product using material and processing must conform to the "WI-PZ-001"HSF technical standard control requirements

RoHS+HF

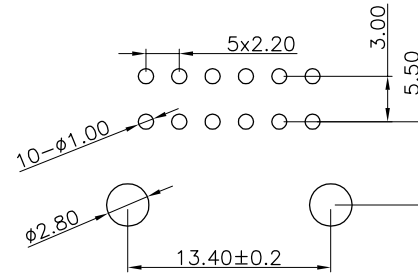

PCB Layout

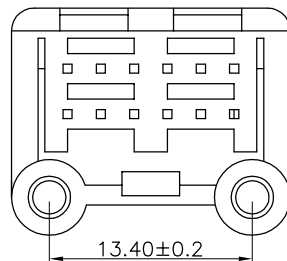
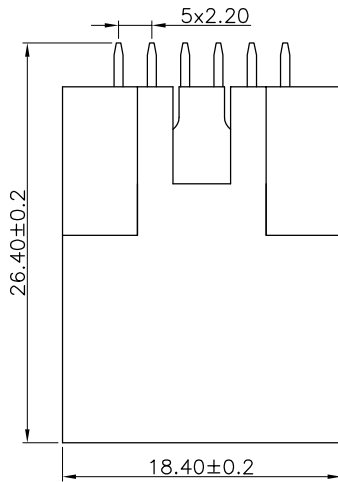
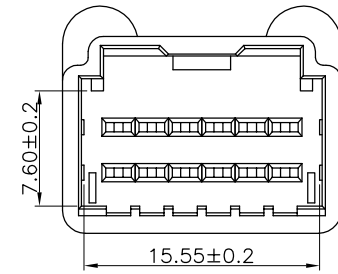
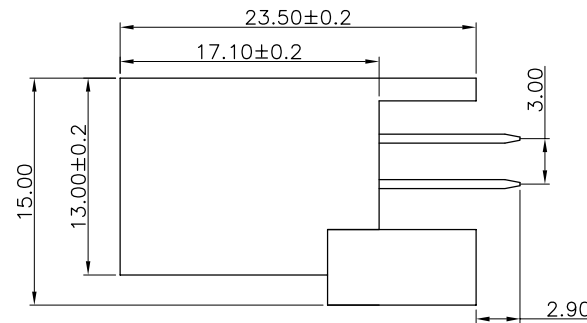

NOTE:

- 1.MATERIAL SPECIFICATION:
 - 1-1.HOUSING:PA66,UL94V-0
 - 1-2.CONTACTS:BRASS H62
- 2.PLATING SPECIFICATION:
 - 2-1.CONTACTS:TIN PLATED ON CONTACT AREA.
- 3.MECHANICAL PERFORMANCE:
 - 3-1.INSERTION FORCE: 1KGF/PIN MAX
 - 3-2.REMOVAL FORCE: 3KGF/PIN MIN
 - 3-3.DURABILITY: 50 CYCLES.
- 4.ELECTRICAL PERFORMANCE:
 - 4-1. RATED CURRENT : 10A
RATED VOLTAGE : 250V
 - 4-2.INSULATION RESISTANCE: 1000MΩ MIN
CONTACT RESISTANCE : 30mΩ MAX
 - 4-3.WITHSTANDING VOLTAGE:1500V AC
- 5.ENVIRONMENTAL PERFORMANCE:
 - OPERATING TEMPERATURE: -40°C~+90°C.
- 6.PACKAGE SPEC:TRAY
- 7.P/N:

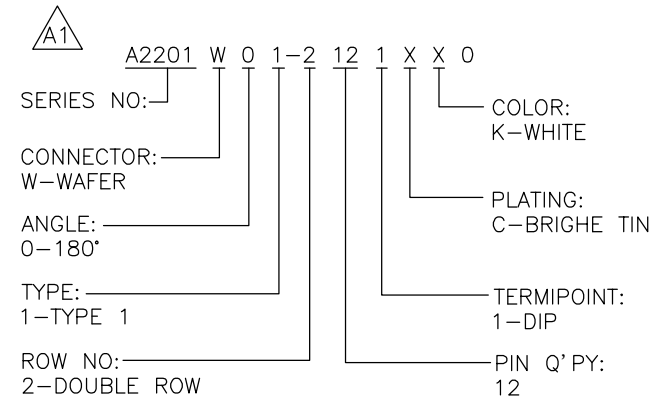

REV.	REVISION RECORD	DATE	GENERAL TOLERANCES		SCALE:	NAME	DATE	PART.NO:	DWG.NO:	 万连科技 WanLian Technology Co., Ltd
A0	NEW RELEASE	21.01.13	LINEAR	ANGLES	1:1	Wang_jr	23.10.07	A2201W01-2121XX0	ENDE05	
A1	PART NUMBER RENEWAL	23.10.07	0.0±0.35	X°REF±6°	APPROVED	Han_Gao	23.10.07	TITLE: PITCH 2.20mm 180° 立插带扣 汽车连接器	REV: A1	SHEET: 1/1
			UNIT:mm	X°±3°	DESIGNER	Zijun_Huang	23.10.07			
			SIZE: A4	0.000±0.10	DRAWN					