

The product using material and processing must conform to the "WI-PZ-001"HSF technical standard control requirements

RoHS+HF

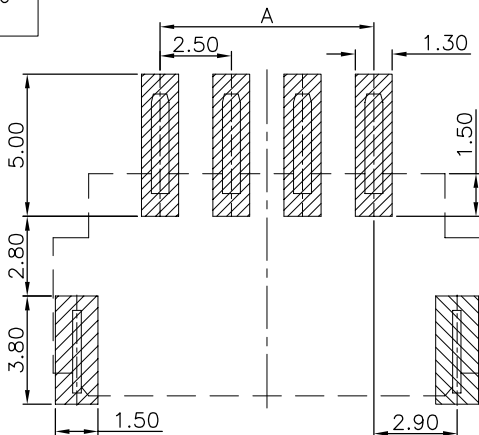

RECOMMENDED PCB LAYOUT
(GENERAL TOLERANCE:±0.05)

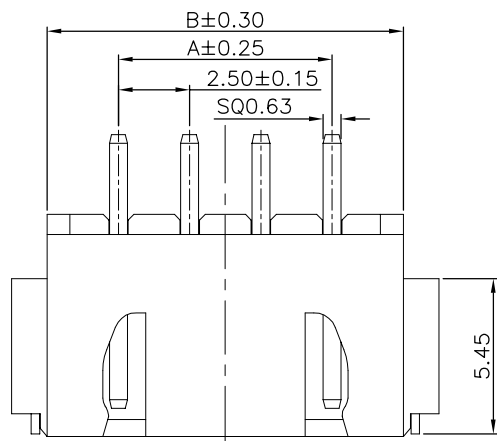
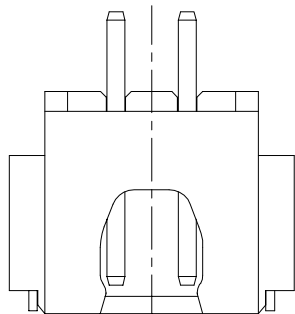
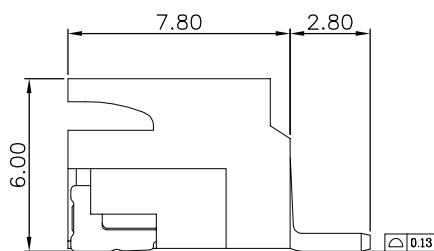
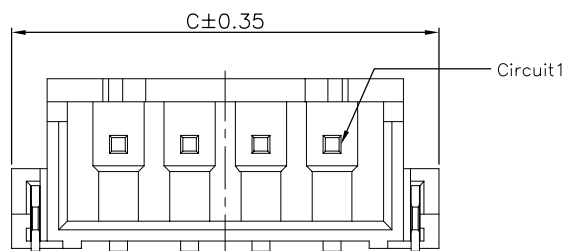

2PIN

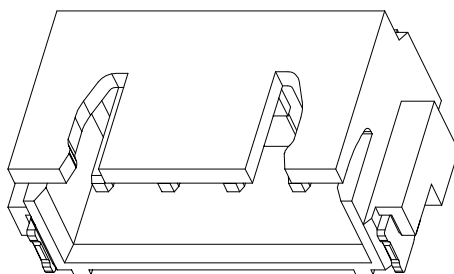

NOTE:

- MATERIAL SPECIFICATION:
 - 1-1.HOUSING:LCP, 94V-0
 - 1-2.PIN:BRASS
 - 1-3.SOLDER TABS:BRASS
- PLATING SPECIFICATION:
 - 2-1.PIN:TIN PLATED ON CONTACT AREA.
 - 2-2.SOLDER TABS:TIN PLATED ON CONTACT AREA.
- ELECTRICAL PERFORMANCE:
 - 3-1.RATED CURRENT : 3A
 - 3-2.INSULATION RESISTANCE: 1000MΩ MIN
 - 3-3.CONTACT RESISTANCE : 20mΩ MAX
 - 3-4.WITHSTANDING VOLTAGE:1000V AC/minute
- ENVIRONMENTAL PERFORMANCE:
 - OPERATING TEMPERATURE: -25°C~+85°C.
- PACKAGE SPEC: REEL
- P/N:

$\triangle A1$ A2501 W 9-1 XX 2 X X X
 SERIES NO: _____
 CONNECTOR: _____
 W-WAFER
 ANGLE: _____
 9-90°
 ROW NO: _____
 1-SINGLE ROW
 PIN Q'PY: _____
 02~16
 HOUSING:
 1-LCP
 COLOR:
 A-BLACK
 S-NATURE
 PLATING:
 C-BRIGHE TIN
 TERMIPOINT:
 2-SMT

Circuits	Dimensions(mm)			Circuits	Dimensions(mm)		
	A	B	C		A	B	C
02	2.50	7.50	10.00	10	22.50	27.50	30.00
03	5.00	10.00	12.50	11	25.00	30.00	32.50
04	7.50	12.50	15.00	12	27.50	32.50	35.00
05	10.00	15.00	17.50	13	30.00	35.00	37.50
06	12.50	17.50	20.00	14	32.50	37.50	40.00
07	15.00	20.00	22.50	15	35.00	40.00	42.50
08	17.50	22.50	25.00	16	37.50	42.50	45.00
09	20.00	25.00	27.50				

REV.	REVISION RECORD	DATE		GENERAL TOLERANCES		SCALE:	NAME	DATE	PART.NO:	DWG.NO:	
A0	NEW RELEASE	22.01.13		LINEAR	ANGLES	1:1					
A1	PART NUMBER RENEWAL	23.09.13		0.00±0.25	X'±3°	DESIGNER	Han_Gao	23.09.13	TITLE:	Pitch 2.50mm SINGLE ROW 90°SMT WAFER	REV: A1 SHEET: 1/3
				0.00±0.10	X'X' ±2°	DRAWN	LX_HOU	23.09.13			

The product using material and processing must conform to the "WI-PZ-001"HSF technical standard control requirements

RoHS+HF

NOTE(注):

1. 10 SPROCKET HOLE PITCH CUMULATIVE TOLERANCE $\pm 0.2\text{mm}$. (10片孔距累积公差 $\pm 0.2\text{mm}$.)
2. CARRIER CAMBER NOT TO EXCEED 1mm IN 100mm. (载带拱/弧形MAX:1/100mm.)
3. ALL DIMENSIONS MEET EIA-481 REQUIREMENTS. (所有的尺寸要满足协会EIA-481规范.)
4. MATERIAL: CLEAR ANTISTATIC PS, COLD SEALING. (载带材料: 透明抗静电 PS, 冷封.)
5. THICKNESS: $0.35 \pm 0.05\text{mm}$. (载带厚度: $0.35 \pm 0.05\text{mm}$.)
6. PACKING LENGHT PER REEL: 11.6 METERS. (每卷包装长度: 11.6米.)
7. COMPONENT LOAD PER REEL: 700 PCS. (每卷包装数量: 700只.)
8. 纸箱装箱以不超过装箱线为准, 空余位置用塑料泡沫及保尼龙填充.
9. 纸箱分小、中、标准型3种规格型号; 装箱为整箱(左下包装量)采用标准型纸箱包装, 未达到整箱数量以产品量适当采用小型或中型纸箱包装.

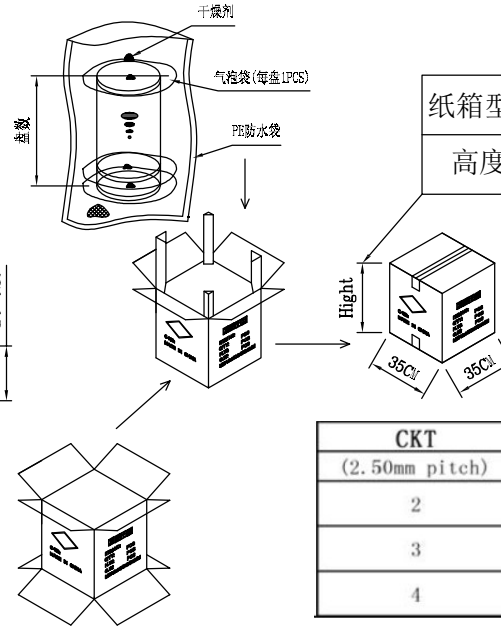
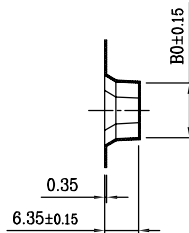
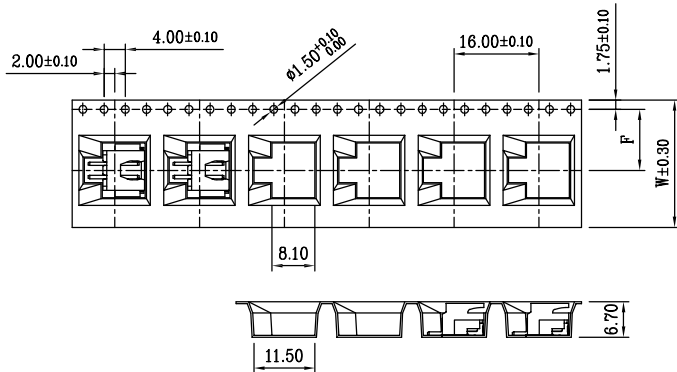
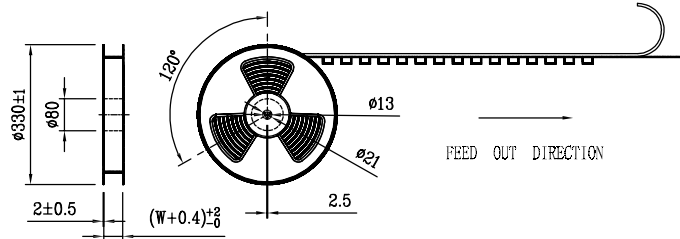
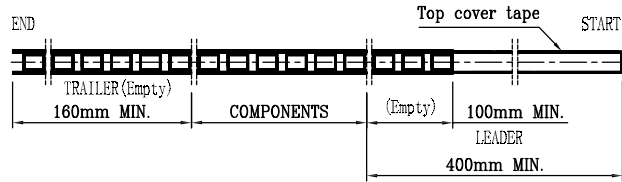

纸箱型号	小型	中型	标准型
高度	7.5	15	32

CKT (2.50mm pitch)	B0	W	F
	2	10.30	24
3	12.80		
4	15.30		

CKT (2.50mm pitch)	W	PCS/RELL	RELL/CARTON	SUM(PCS)
2	24	700	10	7000
3		700	10	7000
4		700	10	7000

REV.	REVISION RECORD	DATE	GENERAL TOLERANCES		SCALE:	NAME	DATE	PART.NO:	DWG.NO:
A0	NEW RELEASE	22.01.13	 LINEAR: 0.00 ± 0.25 ANGLES: $X' \pm 3'$	 ANGLES: $X' \text{REF} \pm 6'$ $X' \pm 3'$	1:1	Wang_jr	23.09.13	A2501W9-1XX2XXX	ENDE05
A1	PART NUMBER RENEWAL	23.09.13			UNIT:mm SIZE: A4	0.000 ± 0.10 $X'X' \pm 2'$	APPROVED		
					DESIGNER	LX_HOU	23.09.13	Pitch 2.50mm SINGLE ROW 90°SMT WAFER	

万连科技
WanLian Technology Co., Ltd

REV: A1 SHEET: 2/3

The product using material and processing must conform to the "WI-PZ-001" HSF technical standard control requirements

RoHS+HF

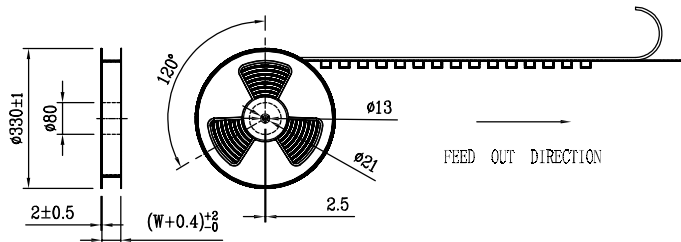
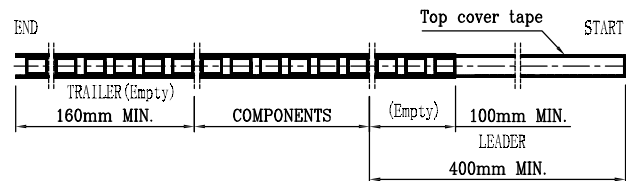

NOTE(注):

1. 10 SPROCKET HOLE PITCH CUMULATIVE TOLERANCE $\pm 0.2\text{mm}$. (10片孔距累积公差 $\pm 0.2\text{mm}$.)
2. CARRIER CAMBER NOT TO EXCEED 1mm IN 100mm. (载带拱/弧形MAX: 1/100mm.)
3. ALL DIMENSIONS MEET EIA-481 REQUIREMENTS. (所有的尺寸要满足协会EIA-481规范.)
4. MATERIAL: CLEAR ANTISTATIC PS, COLD SEALING. (载带材料: 透明抗静电 PS, 冷封.)
5. THICKNESS: $0.35 \pm 0.05\text{mm}$. (载带厚度: $0.35 \pm 0.05\text{mm}$.)
6. PACKING LENGTH PER REEL: 11.6 METERS. (每卷包装长度: 11.6米.)
7. COMPONENT LOAD PER REEL: 700 PCS. (每卷包装数量: 700只.)
8. 纸箱装箱以不超过装箱线为准, 空余位置用塑料泡沫及保尼龙填充.
9. 纸箱分小、中、标准型3种规格型号; 装箱为整箱(左下包装量)采用标准型纸箱包装, 未达到整箱数量以产品量适当采用小型或中型纸箱包装.

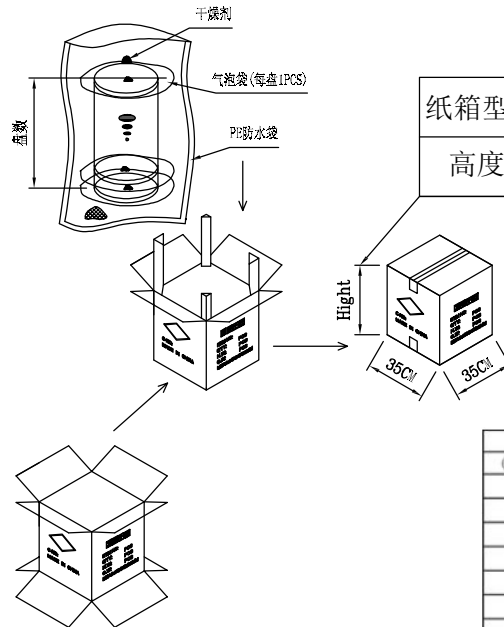
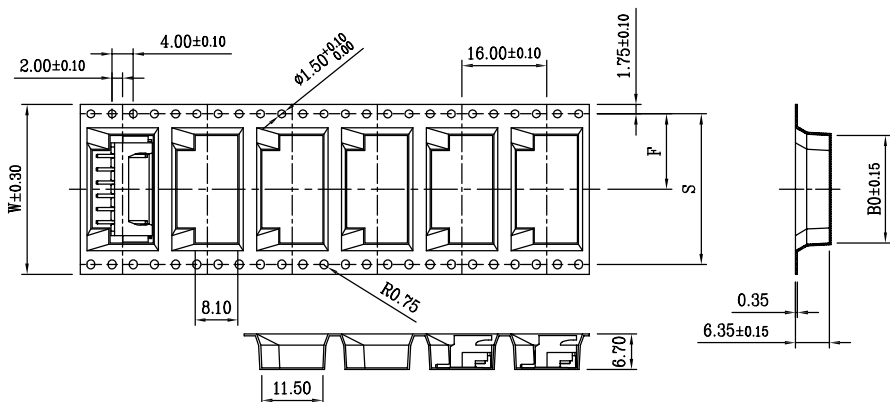

纸箱型号	小型	中型	标准型
高度	7.5	15	32

CKT (2.50mm pitch)	W	PCS/REEL	REEL/CARTON	SUM (PCS)
5	32	700	8	5600
6		700	8	5600
7		700	6	4200
8	44	700	6	4200
9		700	6	4200
10		700	6	4200
11	56	700	5	3500
12		700	5	3500

CKT (2.50mm pitch)	BO	W	F	S
5	17.80	32	14.20±0.10	28.40
6	20.30			
7	22.80			
8	25.30	44	20.20±0.10	40.40
9	27.80			
10	30.30			
11	32.80	56	26.20±0.10	52.40
12	35.30			

REV.	REVISION RECORD	DATE	GENERAL TOLERANCES	SCALE: 1:1	NAME	DATE	PART.NO:	DWG.NO:	 WanLian Technology Co., Ltd
A0	NEW RELEASE	22.01.13	LINEAR	APPROVED	Wang_jr	23.09.13	A2501W9-1XX2XXX	ENDE05	
A1	PART NUMBER RENEWAL	23.09.13	ANGLES	DESIGNER	Han_Gao	23.09.13			
			0.00±0.25	DRAWN	LX_HOU	23.09.13	TITLE:	REV: A1	
			0.000±0.10				Pitch 2.50mm SINGLE ROW 90°SMT WAFER	SHEET: 3/3	