

The product using material and processing must conform to the "WL-PZ-001" HSF technical standard control requirements

RoHS

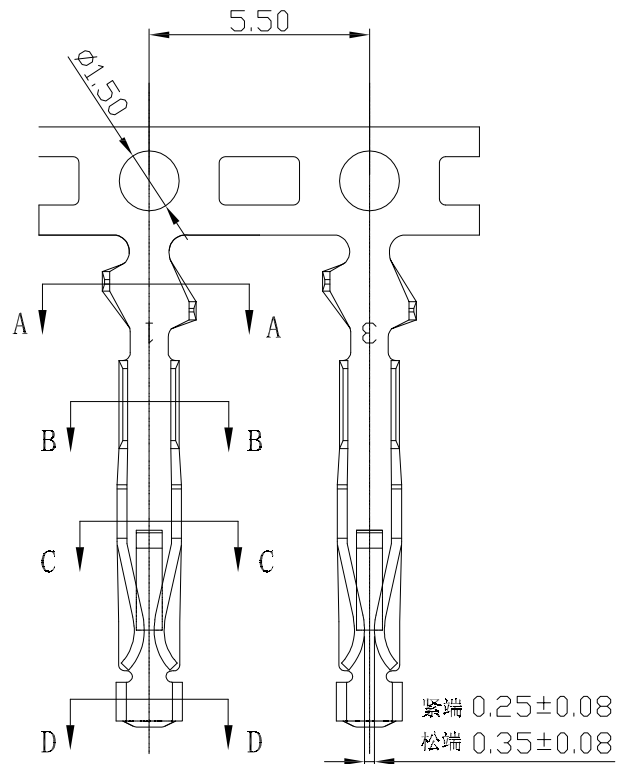

紧端 0.25 ± 0.08
松端 0.35 ± 0.08

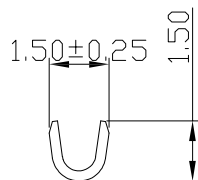
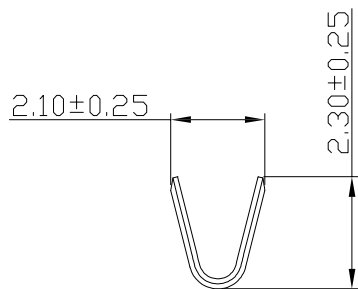
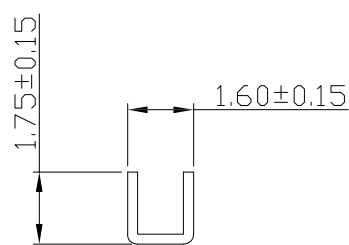
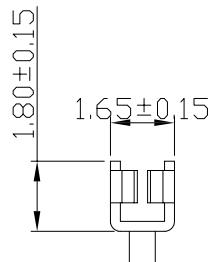
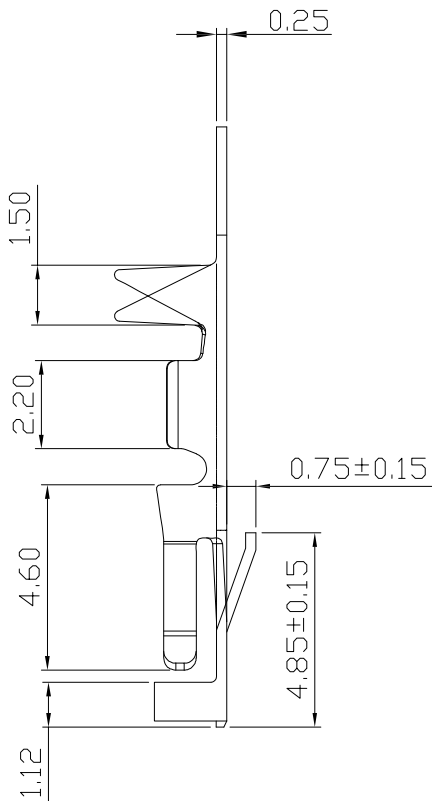

SECTION: A-A

SECTION: B-B

SECTION: C-C

SECTION: D-D

- NOTE:
- MATERIAL SPECIFICATION:
1-1.CONTACTS: PHOSPHOR BRONZE
 - PLATING SPECIFICATION:
2-1.CONTACTS:
TIN/GOLD FLASH PLATED OVER ALL.
 - WIRE RANGE:AWG#22~28
 - ELECTRICAL PERFORMANCE:
4-1.CURRENT RATING: 3A
RATED VOLTAGE : 250V AC/DC
4-2.CONTACT RESISTANCE: 20 mΩ MAX
4-3.INSULATION RESISTANCE: 1000 MΩ Min
4-4.DIELECTRIC WITHSTANDING : 1500V
 - ENVIRONMENTAL PERFORMANCE:
4-1.OPERATING TEMPERATURE: -25°C~+85°C.
 - PACKAGE SPEC: REEL
 - P/N:

SERIES NO: A2547 T X F X-X
CONNECTOR: T-TERMINAL
3-紧端
4-松端
MALE FEMALE: F-FEMALE M-MALE
PLATING:
1-G/F
A-ALL AU G/F
C-BRIGHE TIN
D-MATTE TIN
METAL:
P-PHOSPHOR BRONZE
B-BRASS

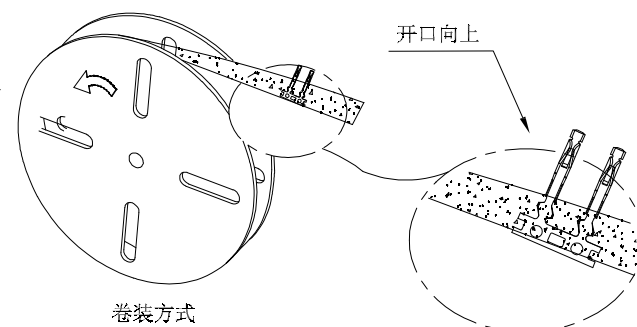

REV.	REVISION RECORD	DATE		GENERAL TOLERANCES		SCALE: 1:1	NAME	DATE	PART.NO:	DWG.NO:	 WanLian Teconology Co., Ltd
AO	NEW RELEASE	22.05.09		LINEAR	ANGLES	APPROVED	Wang_jr	22.05.09	A2547TXFX-X	ENDE05	
			0.0±0.35	X'REF±6'	DESIGNER	Han_Gao	22.05.09	TITLE:			
			UNIT:mm	X'±3'	DRAWN	LanXuan_Hou	22.05.09	Pitch 2.54mm 母端子 AWG#22~#28			
			SIZE: A4	0.000±0.10						REV: A0	SHEET: 1/1