

The product using material and processing must conform to the "WL-PZ-001"HSF technical standard control requirements

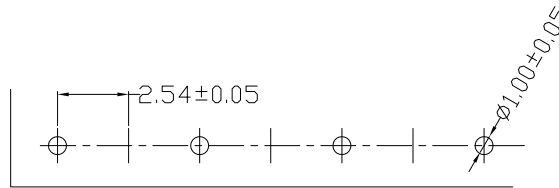

Recomand PCB Layout

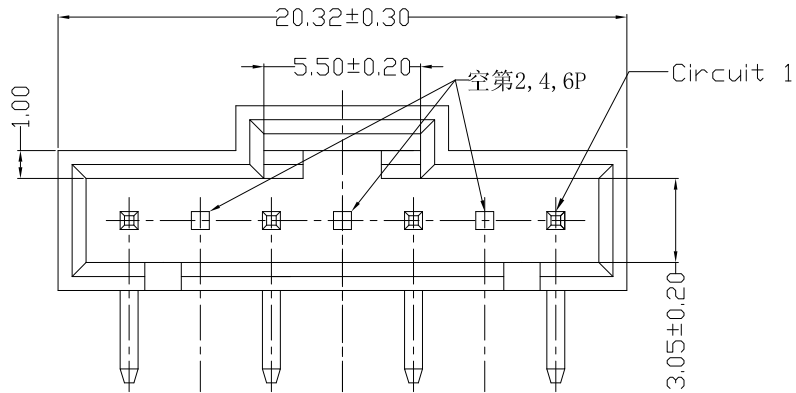
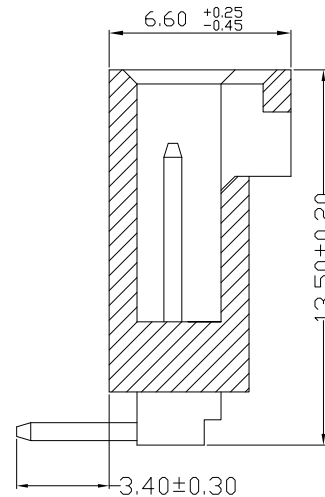
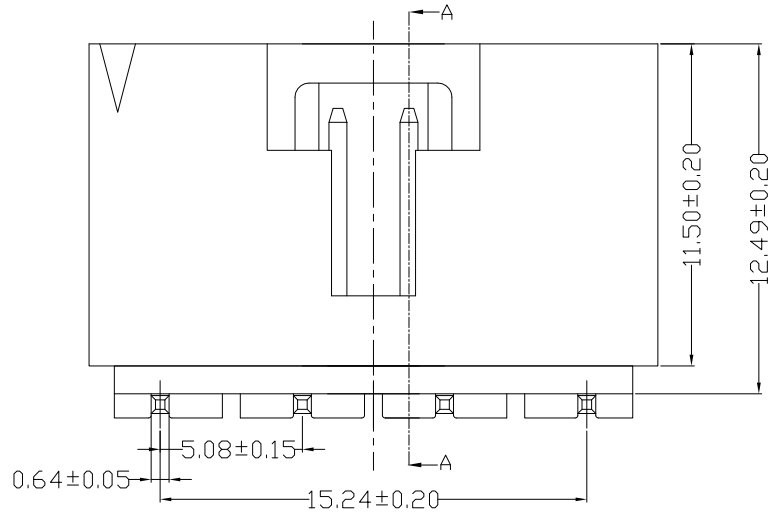

SECTION A-A  
SCALE 1 : 1

- NOTE:
- MATERIAL SPECIFICATION:
    - HOUSING: LCP/PA66,UL94V-0
    - CONTACTS: Brass
  - PLATING SPECIFICATION:
    - CONTACTS: TIN/GOLD FLASH PLATED OVER ALL.
  - MECHANICAL PERFORMANCE:
    - RETENTIVITY FORCE: 1.5KGF/pin min
    - DURABILITY: 50 CYCLES.
  - ELECTRICAL PERFORMANCE:
    - CURRENT RATING: 3A AC,DC
    - RATED VOLTAGE : 250V AC/DC
    - CONTACT RESISTANCE: 20 mΩ MAX
    - INSULATION RESISTANCE: 1000MΩ Min
    - DIELECTRIC WITHSTANDING : 1500V
  - ENVIRONMENTAL PERFORMANCE:
    - OPERATING TEMPERATURE: -25°C~+85°C.
  - PACKAGE SPEC:Pe bag

7.P/N: A2547 W 9 1-1 07 1 X X X

|              |   |   |     |    |   |   |   |   |               |
|--------------|---|---|-----|----|---|---|---|---|---------------|
| SERIES NO:   | W | 9 | 1-1 | 07 | 1 | X | X | X | MATERIAL:     |
| CONNECTOR:   |   |   |     |    |   |   |   |   | 0-LCP RoHS+HF |
| W-WAFER      |   |   |     |    |   |   |   |   | 1-PA66 RoHS   |
| ANGLE:       |   |   |     |    |   |   |   |   | COLOR:        |
| 9-90°        |   |   |     |    |   |   |   |   | A-BLACK       |
| TYPE:        |   |   |     |    |   |   |   |   | K-WHITE       |
| 1-TYPE 1     |   |   |     |    |   |   |   |   | S-NATURE      |
| ROW NO:      |   |   |     |    |   |   |   |   | PLATING:      |
| 1-SINGLE ROW |   |   |     |    |   |   |   |   | A-ALL AU G/F  |
| PIN Q'PY:    |   |   |     |    |   |   |   |   | C-BRIGHE TIN  |
| 07 PIN       |   |   |     |    |   |   |   |   | H-ALL AU 15U" |
|              |   |   |     |    |   |   |   |   | TERMIPOINT:   |
|              |   |   |     |    |   |   |   |   | 1-DIP         |

| REV. | REVISION RECORD | DATE    | UNIT: mm  | GENERAL TOLERANCES |          | SCALE: | NAME        | DATE     | PART.NO:                                  | DWG.NO: | <br>WanLian Teconology Co., Ltd |                  |
|------|-----------------|---------|-----------|--------------------|----------|--------|-------------|----------|---|---------|--|------------------|
| AO   | NEW RELEASE     | 23.9.12 |           | SIZE: A4           | LINEAR   | ANGLES | 1:1         | APPROVED | Wang_jr                                   | 23.9.12 |  | A2547W91-1071XXX |
|      |                 |         | 0.0±0.35  |                    | X°REF±6° |        | DESIGNER    | Han_Gao  | 23.9.12                                   | TITLE:  |  | REV: A0          |
|      |                 |         | 0.00±0.25 | X°±3°              |          | DRAWN  | Zijun_Huang | 23.9.12  | Pitch 2.54mm 90°DIP 卧插带扣 Wafer 空第2, 4, 6P |         |  |                  |