

Circuits Part No	Dimensions		
	A	B	C
2P	--	8.00	0.78
3P	4.00	10.00	1.20
4P	6.00	12.00	1.50
5P	8.00	14.00	1.50
6P	10.00	16.00	1.50
7P	12.00	18.00	1.50
8P	14.00	20.00	1.50
9P	16.00	22.00	1.50
10P	18.00	24.00	7.60
11P	20.00	26.00	7.60
12P	22.00	28.00	7.60
13P	24.00	30.00	7.60
14P	26.00	32.00	7.60
15P	28.00	34.00	7.60
16P	30.00	36.00	7.60

- 12002W00-NP-SF-XX-HF-XX-R  
 ① ② ③ ④ ⑤ ⑥ ⑦ ⑧ ⑨
- ① Series No.
  - ② W90 : Side Contact  
W00 : Up Contact
  - ③ No. of Circuits
  - ④ S : SMT TYPE
  - ⑤ F : A TYPE
  - ⑥ Blank : Bright-Tin  
3E : Matte-Tin
  - ⑦ HF : Halogen Free
  - ⑧ NK : No Mark
  - ⑨ R : Tape & Reel(With Cap)

Specifications:  
 Rated Voltage : 250V AC/DC  
 Rated Current : 3A AC,DC  
 Withstand Voltage : 800V AC/minute  
 Contact Resistance : 10mΩ(MAX.)  
 Insulation Resistance : 1000MΩ(MIN.)  
 Temperature Range : -25°C~+85°C  
 The product using material and processing must conform to the "WI-PZ-142"HSF technical standard control requirements

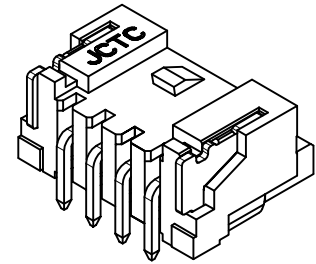

Part No.	Insulator	Cap	PIN/Solder Tabs
12002W00-NP-SF-HF-R	High temperature plastic, UL94V-0/Natural(Beige)	High temperature plastic, UL94V-0	Brass/Bright Tin-plated
12002W00-NP-SF-HF-NK-R			Brass/Bright Tin-plated
12002W00-NP-SF-3E-HF-R			Brass/Matte Tin-plated
12002W00-NP-SF-3E-HF-NK-R			Brass/Matte Tin-plated
12002W00-NP-SF-R			Brass/Bright Tin-plated
12002W00-NP-SF-NK-R			Brass/Bright Tin-plated



REV.	REVISION RECORD	DATE	GENERAL TOLERANCES	SCALE	NAME	DATE	PART NO.	DWG NO.	 TERMINAL&CONNECTORS
A0	The new version file were released	2022.03.07	LINEAR	1:1			12002W00-NP-SF-XX-HF-XX-R	ENDE05	
A1	#PBJ0A202209010006#	2022.09.02	ANGLES	APPROVED					
			0.0±0.25	DESIGNER			TITLE		
			0.00±0.15	DRAWN	JIA	2022.09.02	PA 2.00mm PITCH 180° SMT WAFER		

1 2 3 4 5 6 7 8

A  
B  
C  
D  
E  
F  
G  
H

A  
B  
C  
D  
E  
F  
G  
H

2~5 Contacts

6~16 Contacts

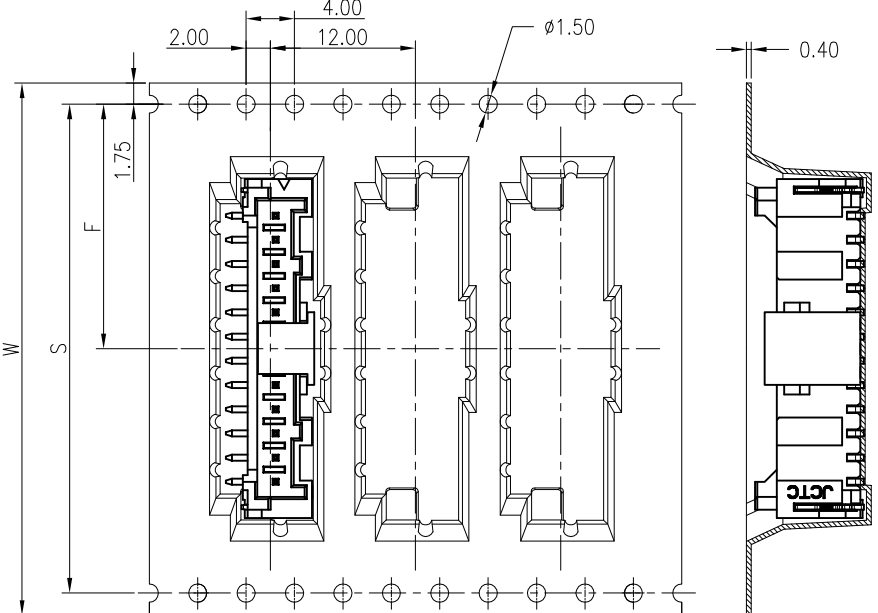
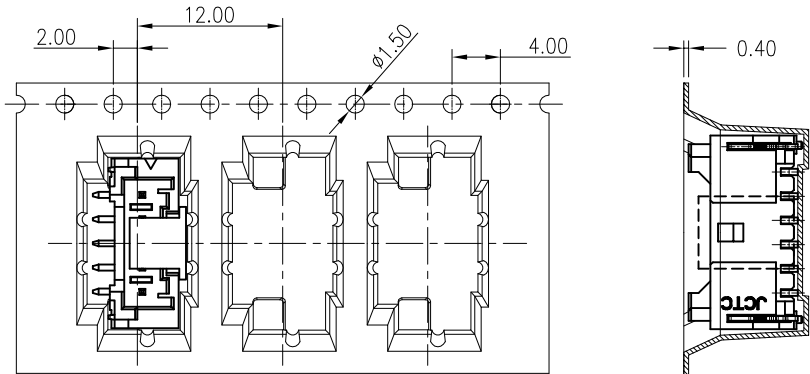

Unreeling direction →

Unreeling direction →

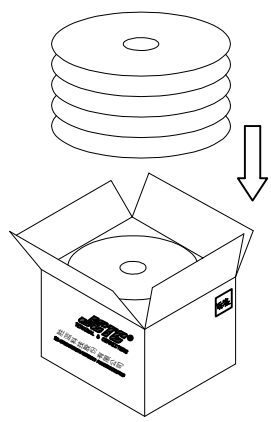
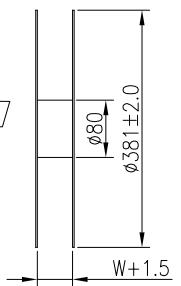
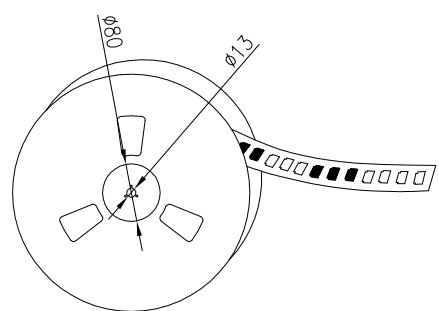
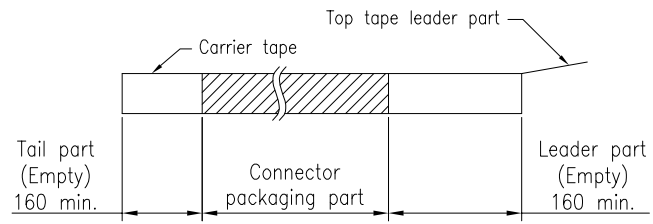

Load carton

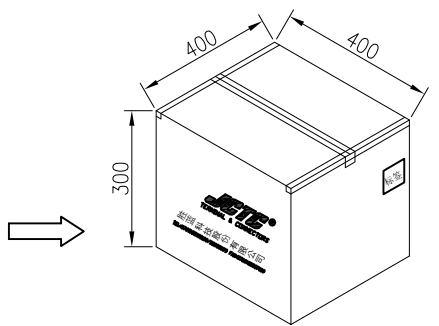

Sealed carton

Number of Contacts	W±0.3	F±0.1	S±0.1	Pcs/Reel	Pcs/Box
2~5P	24	11.50	28.40	800pcs	8000pcs
6~8P	32	14.20	40.40	800pcs	6400pcs
9~16P	44	20.20		800pcs	4800pcs

REV.	REVISION RECORD	DATE	GENERAL TOLERANCES	SCALE 1:1	NAME	DATE	PART NO.	DWG NO.	 <b>JCTC</b> ® TERMINAL&CONNECTORS
A0	The new version file were released	2022.03.07	LINEAR	APPROVED			12002W00-NP-SF-XX-HF-XX-R	ENDE05	
A1	#PBJ0A202209010006##	2022.09.02	0.0 ± 0.25	DESIGNER			TITLE		
			0.00 ± 0.15	DRAWN	JIA	2022.09.02	PA 2.00mm PITCH 180° SMT WAFER		

1 2 3 4 5 6 7 8

REV A1 SHEET 2/2